

Interzum 2025

Product News

SUSTAINABLE DESIGN
AND TECHNOLOGY
FOR YOUR PROJECTS.

ELECTRIFIED
MODULAR SYSTEMS,
SMART HOME
READY PLATFORM,
HIGH EFFICIENCY
LIGHTING AND
LINEAR PROFILES

A technosoft journey through light

We produce lighting systems that integrate into furnishings to evoke emotions and enhance the well-being of people's daily activities.



**SUSTAINABLE
DESIGN**

**IN-HOUSE TESTING
LABORATORIES**

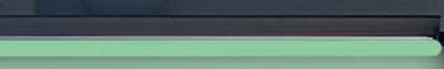

**SMART HOME
ECOSYSTEM**

**INNOVATIVE PATENTED
SOLUTIONS**

**INTERNATIONAL
CERTIFICATIONS**

**GLOBAL PLATFORM
FOR PRODUCTION AND LOGISTICS**

**INTEGRATION
WITH NEW TECHNOLOGIES
AND PROTOCOLS**



We create lighting solutions that enhance design and individual experience.

Sustainable design

We have embarked on a strategic journey to implement product development processes and activities inspired by the principles of the circular economy, collaborating with universities, designers, and research centers: a true investment for the future. At product level, we have focused on the development and improvement of the group's core products:

- Development of a new generation of high-efficiency LED strips that enable energy savings of up to 50% compared to the previous version
- New Mec Lite platform, which reduces the use of components and minimizes bulkiness, thanks to the integrated power supply driver;
- New Moove "free cut" lamps collection, DIY solution customizable to the millimeter
- A new family of free-cut linear profiles, Moove: high-quality finishes and optimal lighting, 30% more than standard LED strips on the market.

Patented and innovative products

Thanks to our expertise in Research and Development and the experience gained in integrating lighting into interior furnishings, we are able to transform your ideas into projects, prototypes, and finished products, working in constant collaboration with the technical departments of our clients. We are the ideal partner for the co-development of lighting solutions, providing added value to your products. The 10 patents obtained for new developments testify to our commitment to innovation.



MOOVE FAMILY

Our technologies for a dynamic light

- Addressable LEDs light to create unique interiors and play with lights to add value to furniture;
- gesture control with the innovative motion detection technology: light that responds to your movements, transforming kitchen lighting into an interactive experience. Turns on, off, and adjusts the light with a simple and gesture, eliminating the need for switches or remote controls;
- smart light system: it's easy to control the light from our remote control, app or voice assistants. We are fully compatible with the most important IoT smart protocols.

Smart Home Ecosystem

With the Mec modular system, we manage lighting easily and offer various options for light control based on needs: from a simple touch of the button connected to the linear light, to the new sensor with three integrated functions (motion, infrared, and touch), up to remote management via transmitter, app, or voice commands. Controlling and personalizing the light becomes extremely easy, thanks to integration with voice assistants and smartphones.





Thanks to our in-house expertise, we are able to meet the needs of diverse users and markets, always ensuring the highest quality.



International certifications

Our products are designed to be easily certifiable according to all major market standards, thus reducing time-to-market. New L&S products are engineered from the outset to effortlessly meet the requirements set by current regulations, anticipating future needs and ensuring quick compliance with regulatory standards.

In-house testing laboratories

We constantly invest in diagnostic and analytical tools for our in-house laboratories to ensure the safety and reliability of our products through continuous testing. We also provide all necessary documentation to obtain any type of certification, offering real-time support for regulatory updates as well.

Global platform for production and logistics

Our international presence, with locations in Europe, China, and the United States, allows us to be integrated into the main furniture manufacturing districts in their respective countries. We offer a global logistics, production, and service platform, ensuring the sharing of know-how. This represents a competitive advantage for both those already operating internationally and those looking to expand into the global market.

Index

Electrified structures	10	Hi Line
	20	Thin Line
Modular systems	24	Sign
Gesture controlled lamps	32	Gesto
Illuminated handle grooves	36	Infinito
"Free cut" Lamps	40	Moove. The free cut family
Linear lamps	48	Micro 4
	50	IVO X
Spotlights	52	Focus
	54	Cora
	56	Zebra
Power supply and control system	58	Mec Lite platform
LED Reels	68	LED Technologies
Accessories	73	Laser door back
	74	IR Tube D8
	75	mini IR
	76	Spider plus

Hi Line

**PATENT
PENDING**



A wall of opportunities

The electrification system for horizontal paneling that integrates linear lighting, creating blades of diffused light with great visual impact

The structural aluminum profiles conceal a practical track electrification system that allows for the integration of elegant aluminum shelves with built-in lighting into the paneling. This is an aesthetic and functional solution that eliminates the need for visible cables and simplifies the installation process.

Hi Line is a customizable and versatile system that enhances living and exhibition spaces with the option to integrate aluminum storage modules, linear lighting, or Solaris light panels to create captivating light effects.

IDEAL FOR

- every residential environment
- retail

FEATURES

- modular and versatile
- easy installation
- cable-free electrification of shelves
- decorative lighting and furniture element



Component schedule

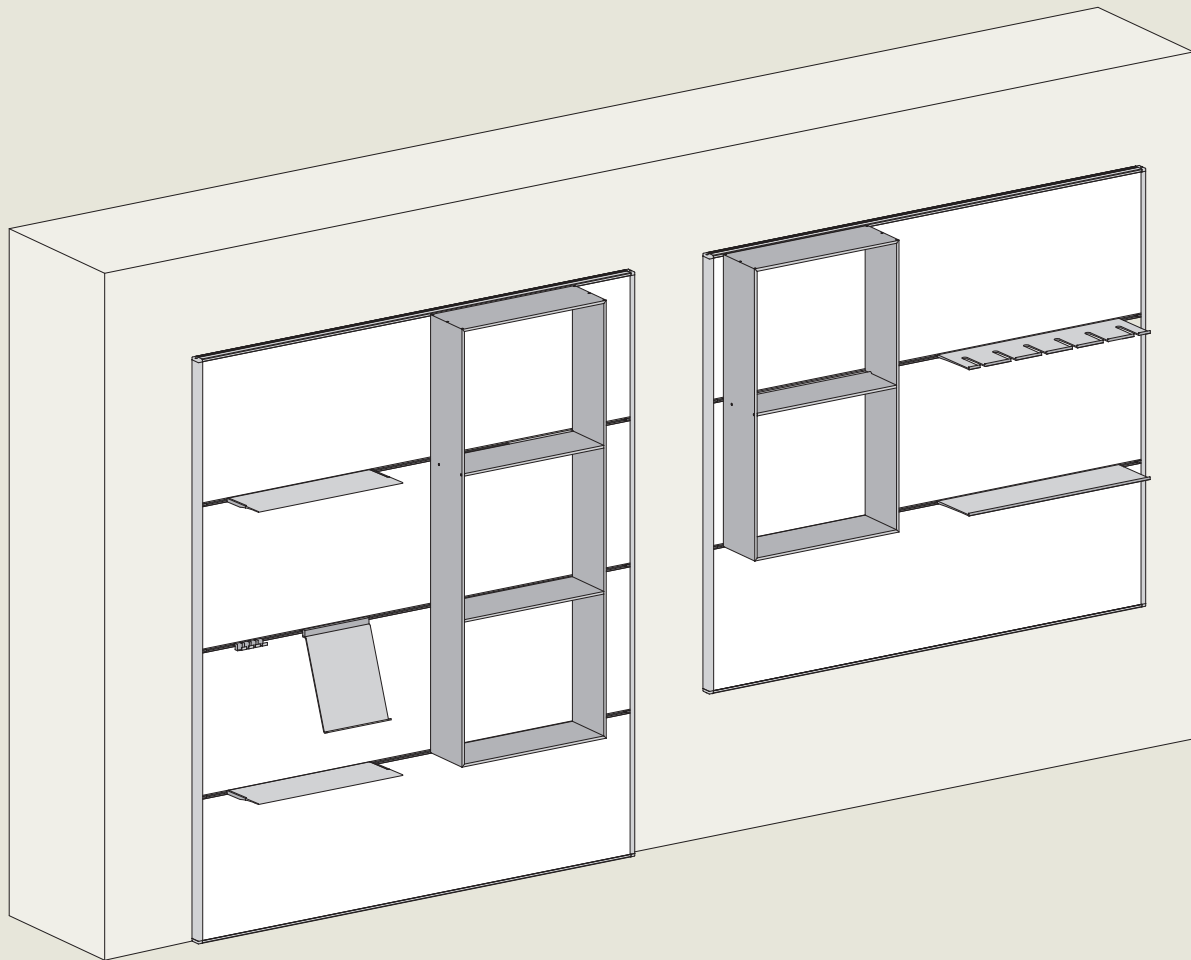

The Hi Line system allows the configuration of electrified structures for horizontal wall-paneling, enabling the wireless integration of light fixtures and aluminium accessories.

The modular electrified structure can be installed as either a floor-mounted or suspended element and can be integrated with upper or lower linear wall-washer lighting.

Hi Line Hi Line is compatible for use with 19mm wooden back panels (by the furniture maker)

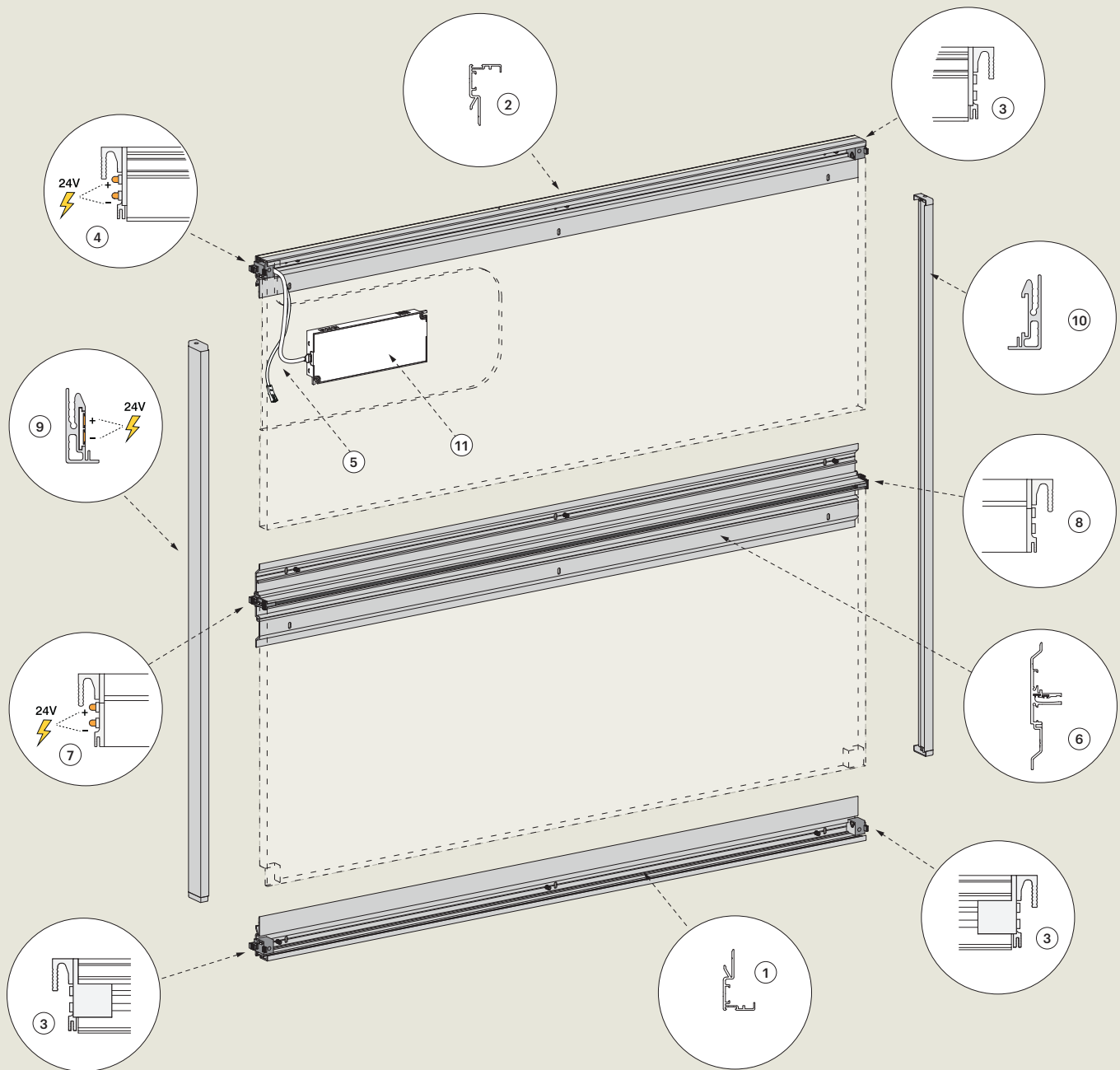

1. Lower closing profile
2. Upper closing profile (**electrified**)
3. Side profile mounting bracket, installed on closing profile
4. **Cabled electrified** side profile mounting bracket, installed on closing profile
5. **Electrified** mounting bracket wiring
6. Rear profile, **electrified**, complete with concealed conductive tracks

7. **Electrified** side profile mounting bracket, installed on rear profile
8. Side profile mounting bracket, installed on rear profile
9. **Electrified** side profile, complete with concealed conductive tracks
10. Side profile
11. LED Driver (not included)
12. Wooden back panel (by the furniture maker)

Repositionable illuminated shelf

03 Black

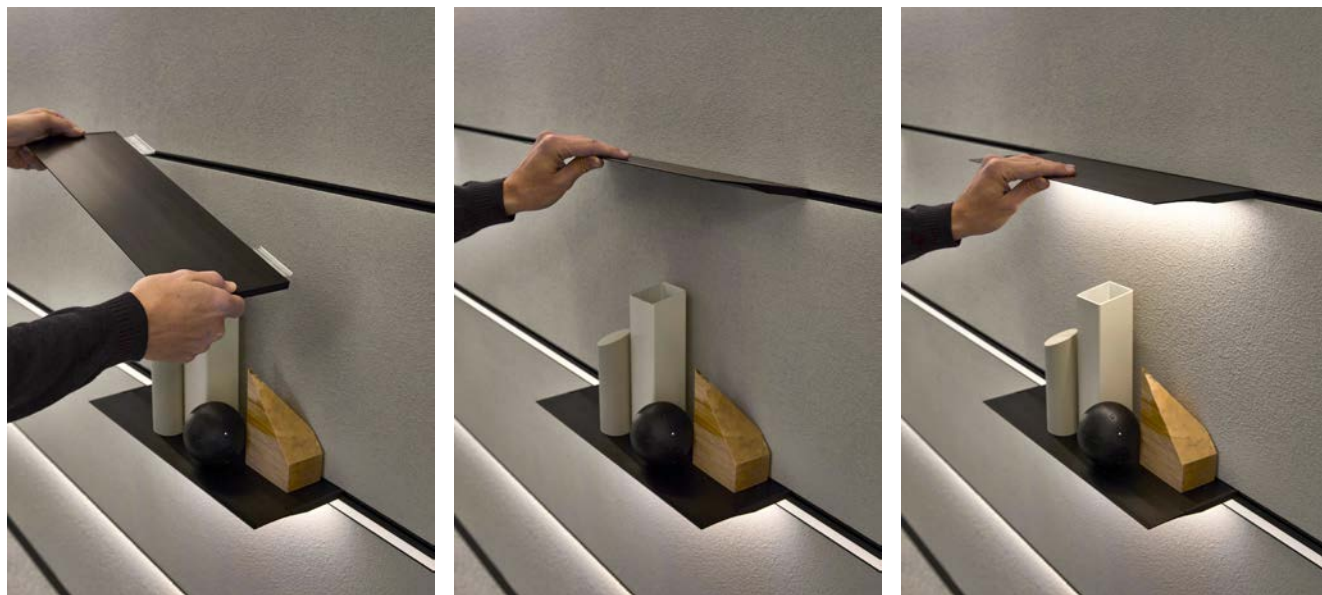

- Thin and elegant, only 2mm thick at the front, the Hi Line luminous shelves enhance every space by creating blades of diffused light with great visual impact
- Easy and intuitive assembly
- Without cables, powered by the paneling rear profile (6) via plastic insulated shelf bracket
- Made of brushed, scratch-resistant extruded aluminum in black finish, with polycarbonate screen cover and plastic sides
- Maximum load: 5Kg evenly distributed
- EDC Dual Color LED source with adjustable color temperature (3000K or 4000K)

**24V DC | LED 10W/m**

EDC 3000K-4000K

L (mm)= 600 / 900 / 1200 / 1500

on request

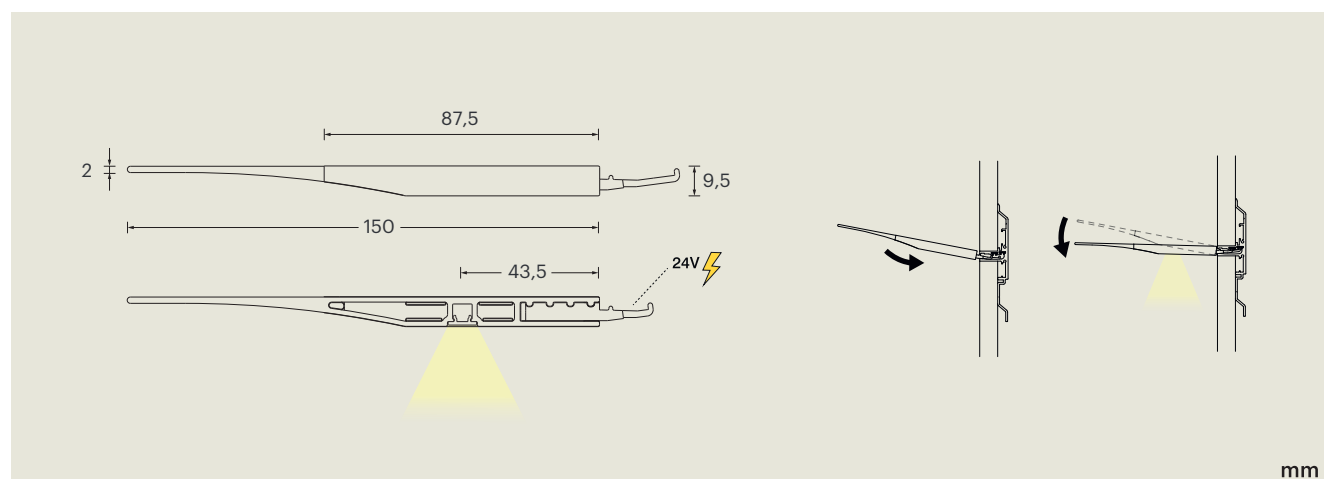

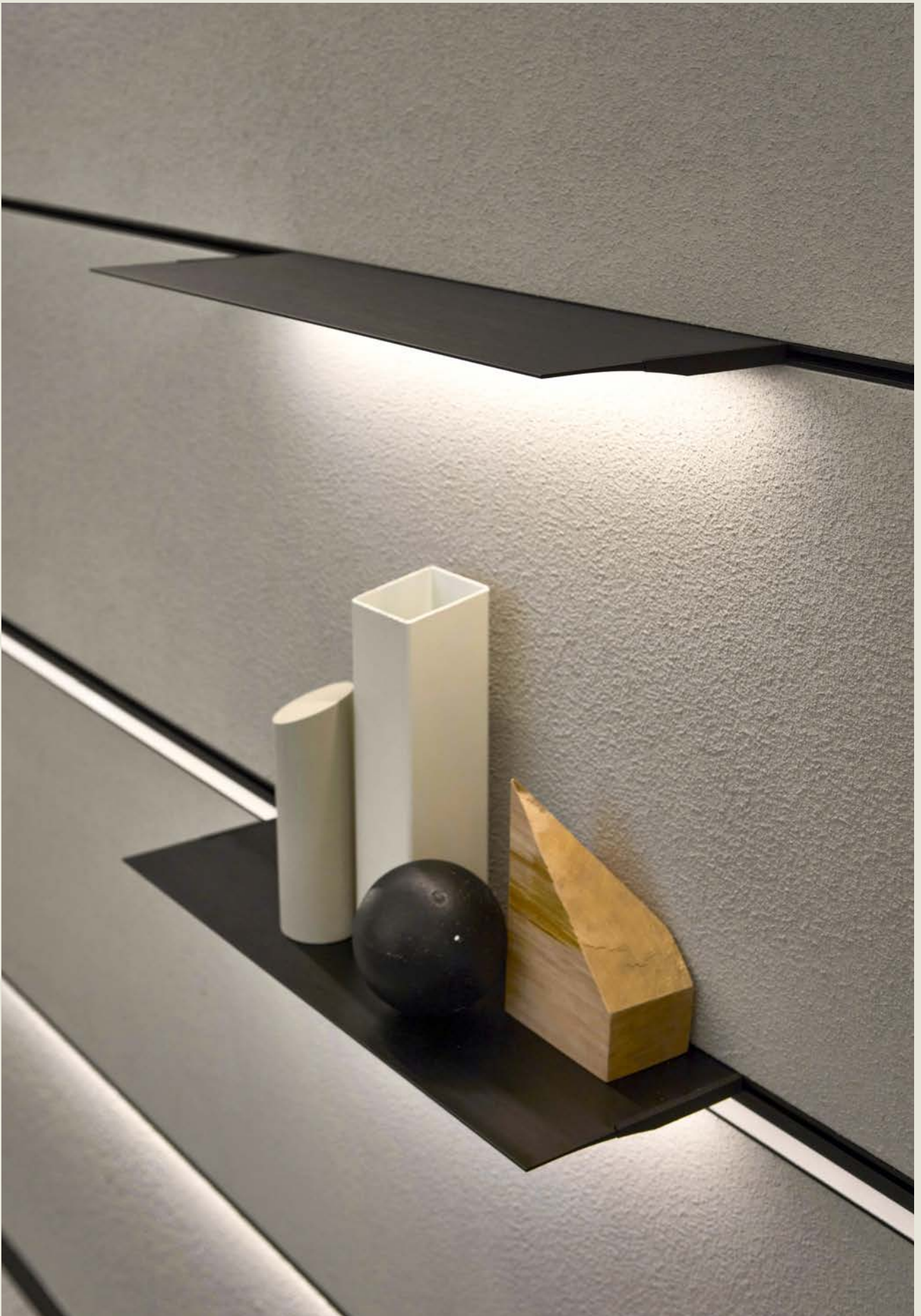



Magnetic linear lamp

03 Black

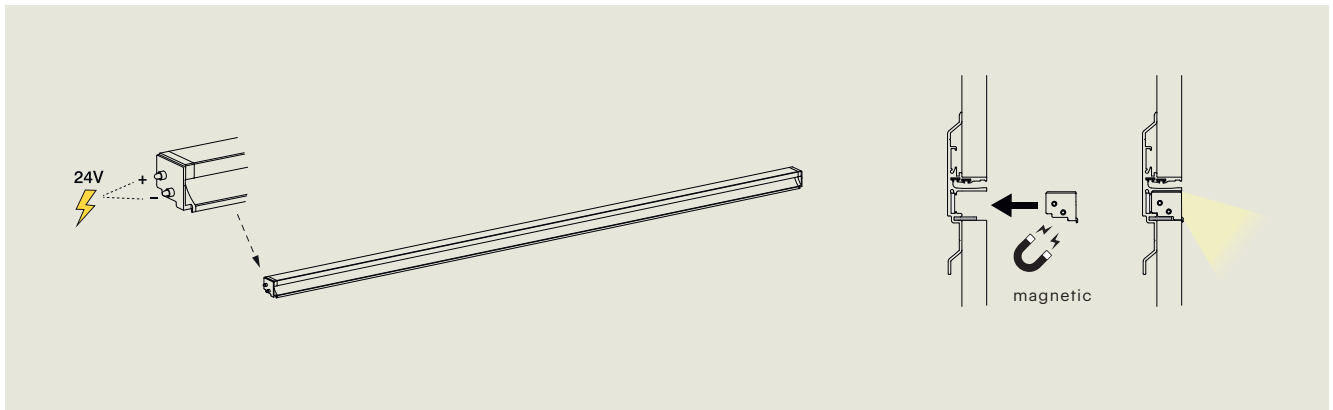

- Without cables: powered by electrified side profile (9) via electrified pin contacts on the sides
- Easy magnetic fixing inside rear profile (6)
- Made of extruded aluminum in black finish, complete with polycarbonate screen cover
- EDC Dual Color LED Light source, with adjustable color temperature (3000K or 4000K)

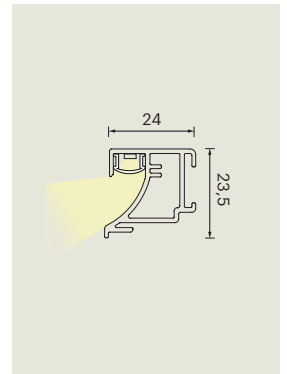
**24V DC | LED 10W/m**

EDC 3000K-4000K

L (mm)= 600 / 900 / 1200 / 1500 / 1800

on request

Wall-Washer LED

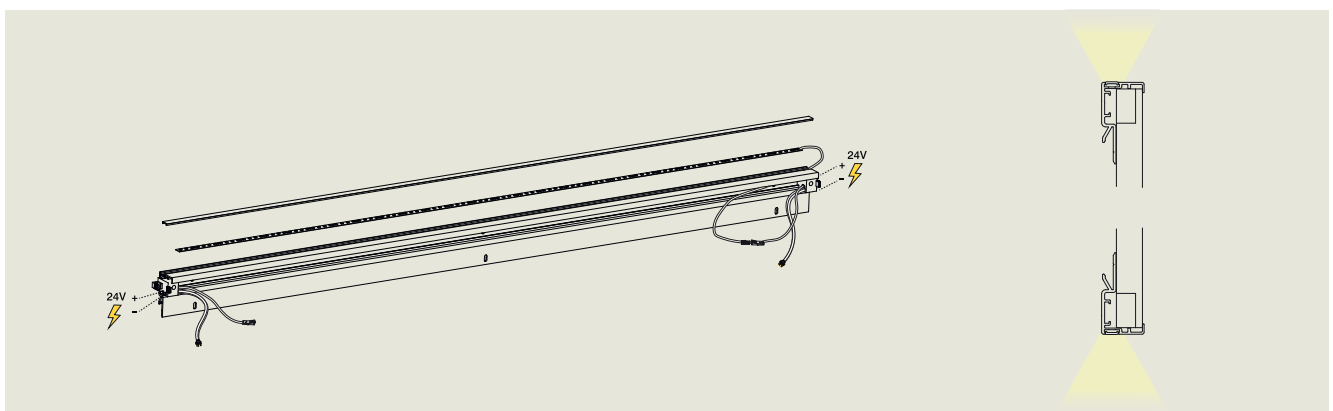

- Supplied installed in the lower (1) or upper (3) closing profiles
- Powered via cable, connected to cabled electrified side profile mounting bracket (4)
- EDC Dual Color LED Light source, with adjustable color temperature (3000K or 4000K)

24V DC | LED 10W/m

EDC 3000K-4000K

custom

Illuminated cabinet modules

03 Black

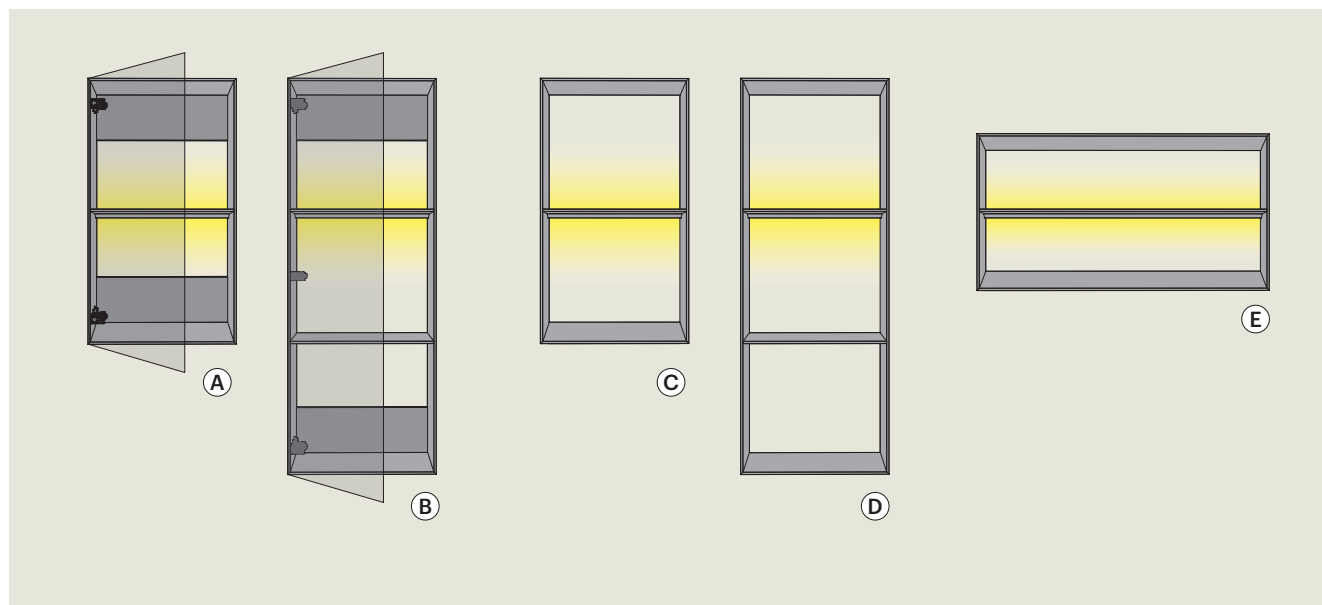

- Horizontal or vertical modules made of black scratch-resistant brushed aluminium
- Available in open version or with single door in Stopsol smoked glass
- Fixed depth 150mm
- Maximum load: 1Kg every 100mm
- Integrated double emission (upper and lower) light shelf without cables, powered by the paneling rear profile (6) via plastic insulated shelf bracket
- EDC Dual Color LED Light source, with adjustable color temperature (3000K or 4000K)

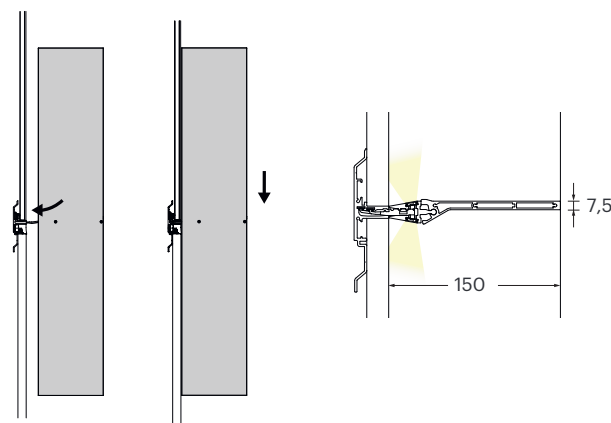

24V DC | LED 10W/m

EDC 3000K-4000K

VERTICAL MODULES WITH STOPSOL GLASS DOOR

A	450 x 150 x h 800mm	2 x compartments	8,6W	523100003
B	450 x 150 x h 1200mm	2 x compartments	8,6W	523100004

VERTICAL MODULES

C	450 x 150 x h 800mm	2 x compartments	8,6W	523100001
D	450 x 150 x h 1200mm	3 x compartments	8,6W	523100002

HORIZONTAL MODULES

E	600 x 150 x h 450mm	2 x compartments	11,6W	523100006
	900 x 150 x h 450mm	2 x compartments	17,6W	523100005

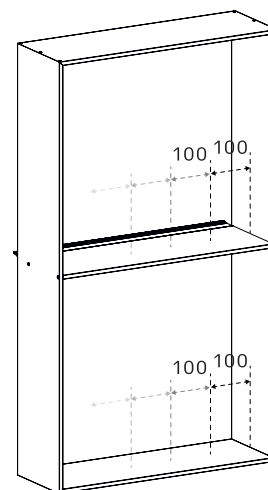

max: 1kg x 100mm

Cabinet modules

03 Black

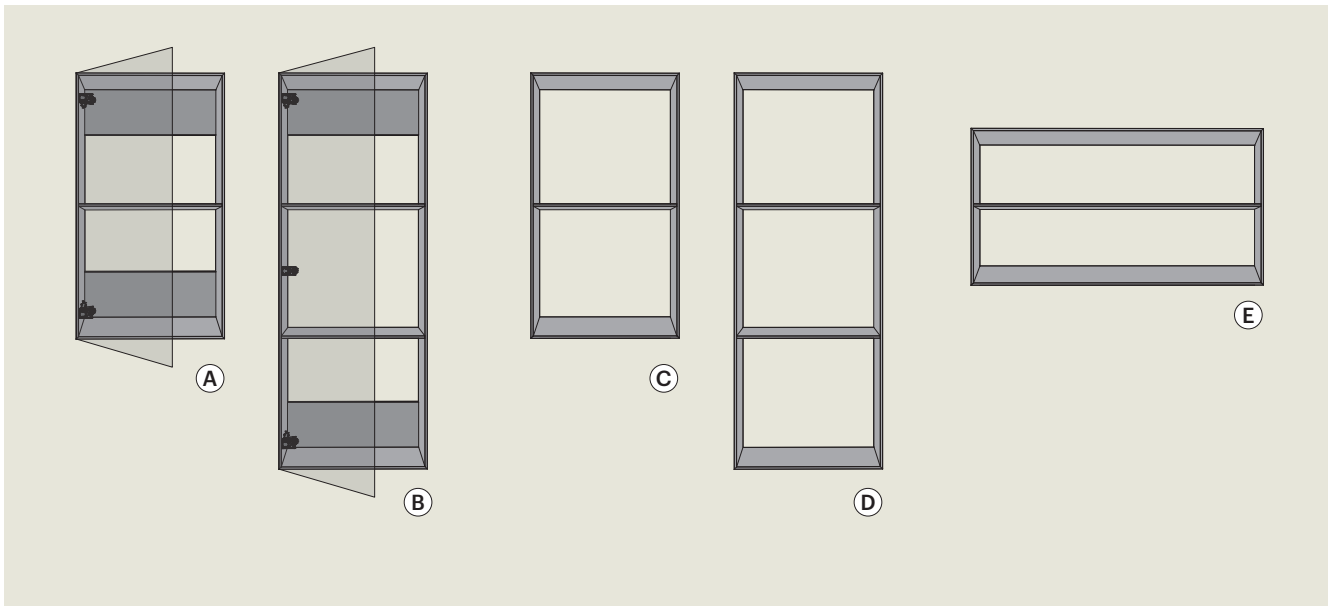

- Horizontal or vertical modules made of black scratch-resistant brushed aluminium
- Snap-fit installation on paneling real profile (6)
- Available in open version or with single door in Stopsol smoked glass
- Fixed depth 150mm
- Maximum load: 1Kg every 100mm

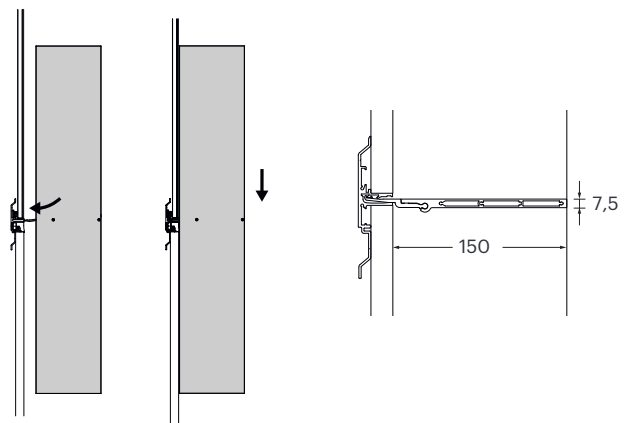

VERTICAL MODULES WITH STOPSOL GLASS DOOR

A	450 x 150 x h 800mm	2 x compartments	92900210300
B	450 x 150 x h 1200mm	2 x compartments	92900220300

VERTICAL MODULES

C	450 x 150 x h 800mm	2 x compartments	92900050300
D	450 x 150 x h 1200mm	3 x compartments	92900060300

HORIZONTAL MODULES

E	600 x 150 x h 450mm	2 x compartments	92900250300
	900 x 150 x h 450mm	2 x compartments	92900240300

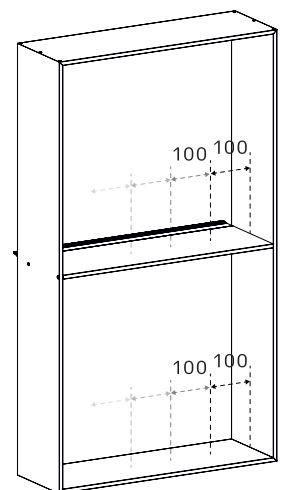

max: 1kg x 100mm

Thin Line

PATENTED



A wall of opportunities

The innovative modular electrified system for boiserie and vertical panels patented by L&S, integrating functional new accessories

Directional lighting, positioned only where necessary, enhances walk-in closets, living areas, and commercial spaces.

With the integration of Lite Track rail, now compatible with Thin Line, it's possible to use new lighting solutions, such as practical magnetic-mount adjustable micro-spotlights that emphasize the illuminated object.

The new mounting system for backs is an aesthetic and functional solution that allows for easier and more precise installation, reducing the gap between panels.

IDEAL FOR

- clothing
- eyewear
- fashion accessories
- cosmetics
- pharmacy
- luxury retail

FEATURES

- modularity
- versatility
- no need for connectors



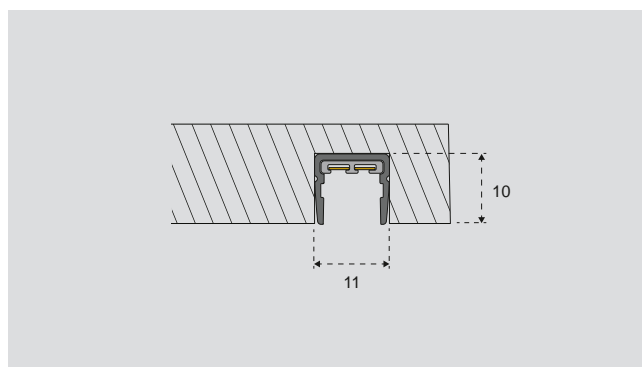
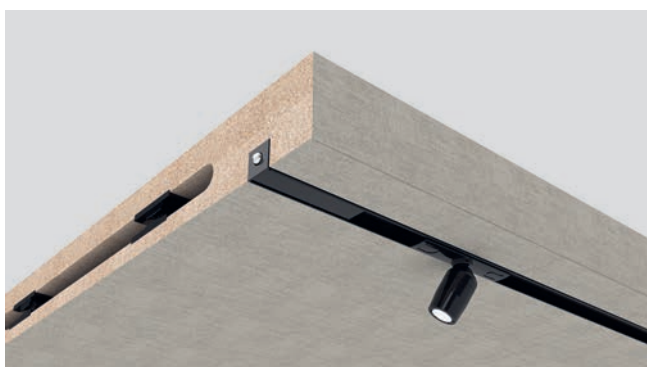
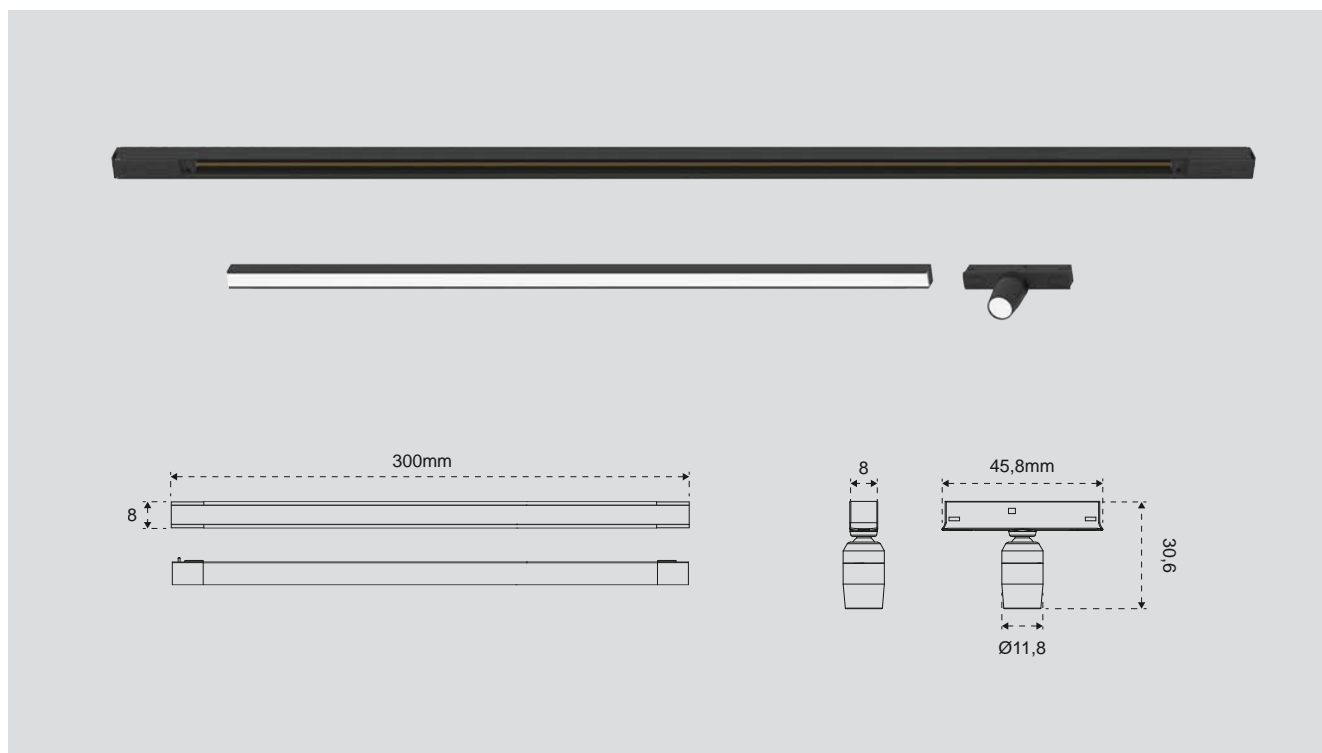

Electrified track for adjustable spotlights with magnetic mounting

Directional lighting, positioned only where necessary: the Lite Track electrified rail, now available with integrated spring electrification contacts, is the ideal solution to conceal the light source and focus attention on the illuminated object. It features recessed installation with only 11mm in width and an elegant black finish, allowing for the easy accommodation of miniaturized adjustable spotlights and linear lamps through magnetic mounting.

Easier and more precise mounting of backs

Easy and quick to install, the new plastic spacer greatly simplifies the sliding and fitting assembly of the panel backs onto the vertical supports: it is securely screwed to the back of the panel and accurately aligned using the removable corner template.

An aesthetic solution that reduces the gap between panels

The spacer allows for the installation of panels in a forward position, overlapping the aluminum support, which is completely concealed. This is an aesthetic and functional solution that reduces the gap between panels, creating an elegant continuous surface effect, with the option to use thick panels without the need for edge finishing.

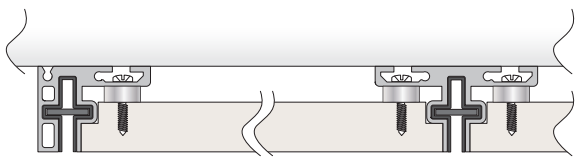
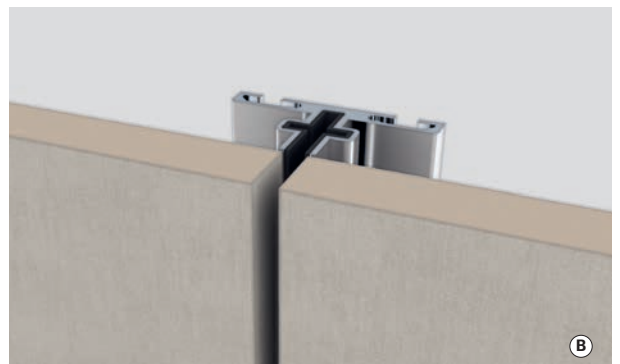
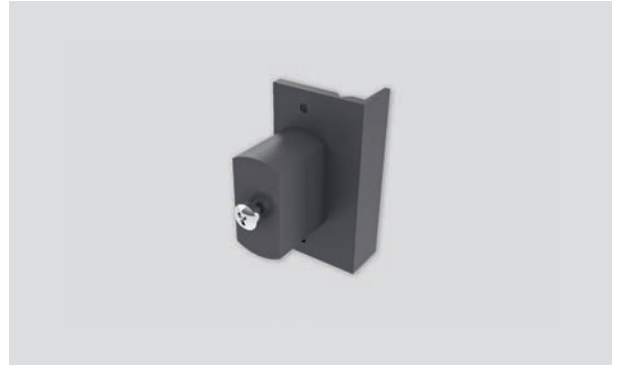

Ⓐ Standard installation with visible vertical support

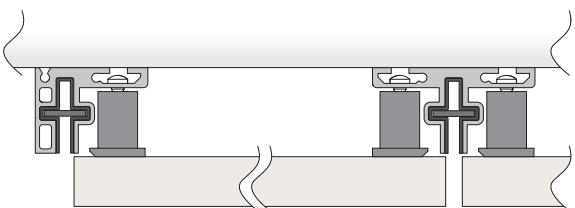

Ⓑ Installation with plastic spacer

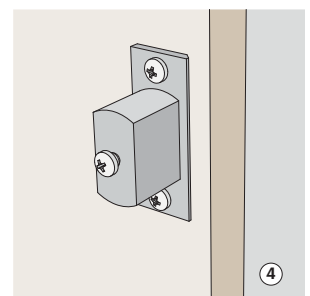
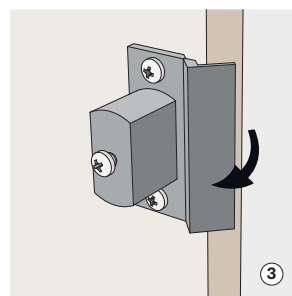
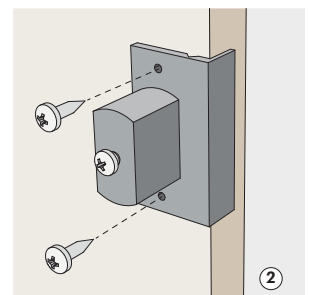
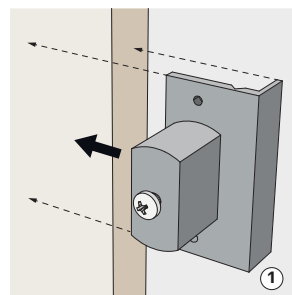

Sign



Shape and finish

Modern aesthetics and refined finishes for a more than unique combination of light and furniture

Sign is renewed and introduce new elegant finishes such as Champagne and Anthracite Grey to the standard brushed black, also adding to the accessories range new aluminium cabinet modules with rounded corners, decorative and with great visual impact. Sign Round, the new mirror module with curved lines, in which the light harmoniously follow the shapes, offering new aesthetic and functional possibilities in every environment. New range of accessories made in modern shapes with sophisticated materials such as smoked glass and matt black metal wire to embellish the horizontal light bar

IDEAL FOR

- any indoor environments
- damp locations (IP44)

FEATURES

- versatile and functional
- easy installation
- range of accessories and cabinets
- furnishing light







Sign stands out once again for its elegance and versatility, integrating light with the architecture of spaces to create exclusive atmospheres: a unique aesthetic solution that enhances every indoor environment.



SIGN - Cabinet modules - Radius 20mm



VERTICAL OPEN MODULES

New design with rounded corners (R 20mm): snap-fit installation on Sign profile, made of black scratch-resistant brushed aluminium (other finishes on request).

A	3x Compartments	300 x 760 x 150mm	910700163
		450 x 760 x 150mm	910700166
		600 x 760 x 150mm	910700164
		900 x 760 x 150mm	910700165
B	3x Compartments	300 x 880 x 150mm	910700167
		450 x 880 x 150mm	910700168
		600 x 880 x 150mm	910700169
		900 x 880 x 150mm	910700170
C	4x Compartments	300 x 1300 x 150mm	910700171
		450 x 1300 x 150mm	910700172
		600 x 1300 x 150mm	910700173
		900 x 1300 x 150mm	910700174

SIGN - Cabinet modules - Radius 20mm

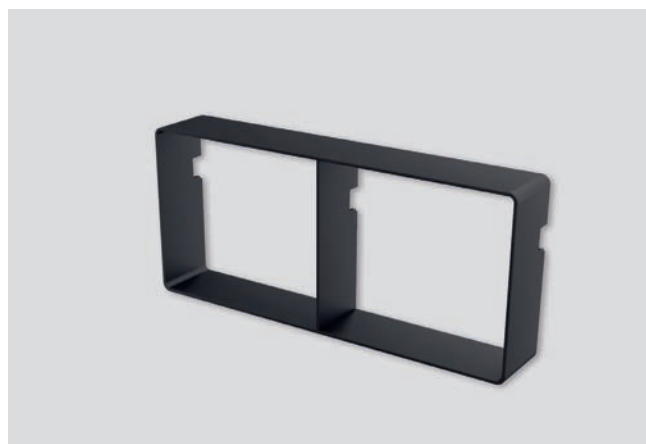
**HORIZONTAL OPEN MODULES**

New design with rounded corners (R 20mm): snap-fit installation on Sign profile, made of black scratch-resistant brushed aluminium (other finishes on request).

A	1x Compartment	300 x 400 x 150mm	910700158
		450 x 400 x 150mm	910700159
		600 x 400 x 150mm	910700160
B	2x Compartments	900 x 400 x 150mm	910700161
C	3x Compartments	1200 x 400 x 150mm	910700162

SIGN - Illuminated mirrors

**SIGN ROUND - Radius 60mm**

Bathroom mirror made of black scratch-resistant brushed aluminum, complete with high-efficiency LED perimeter light integrated into the structure and touch controls (ON-OFF / color temperature / anti-fog). Snap-fit installation on Sign profile. Other sizes on request.

900 x 600H x 150mm
LED EDC Dual Color
3000K-4000K

upon request

Glass shelf



Glass spice holders

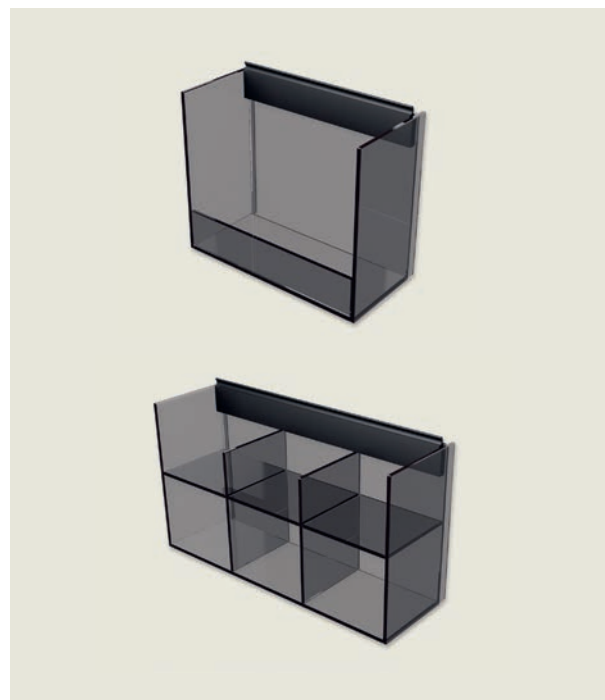
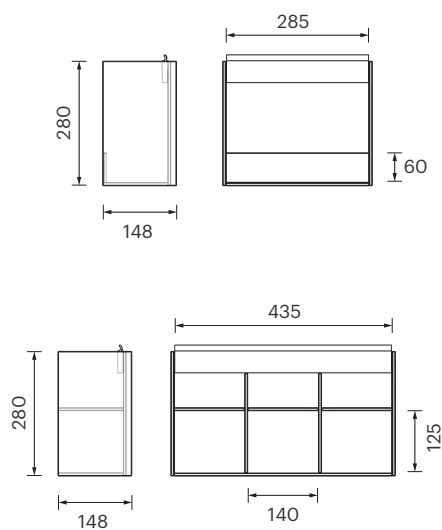

Metal wire cantilever shelf

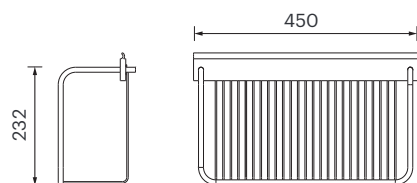

Metal wire shelf

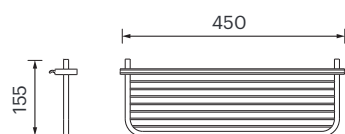



Gesto

**PATENT
PENDING**



VIDEO

Handy! Hand control

Smart lighting with innovative technology for gesture control of light in the kitchen.

Gesto is the linear under-cabinet lamp that responds to your movements, transforming kitchen lighting into an interactive experience. A perfect combination of functionality and design, Gesto incorporates special sensors with motion detection technology at both ends: the lamp turns on, off, and adjusts with a simple gesture of your hands, allowing you to easily customize the position and width of the beam of light to create the illumination you need.

- Switching ON / OFF
- Segmenting
- Dynamic segment control
- Segment shift
- Dimming

IDEAL FOR

- kitchen

FEATURES

- gesture control
- directional LED
- functional lighting

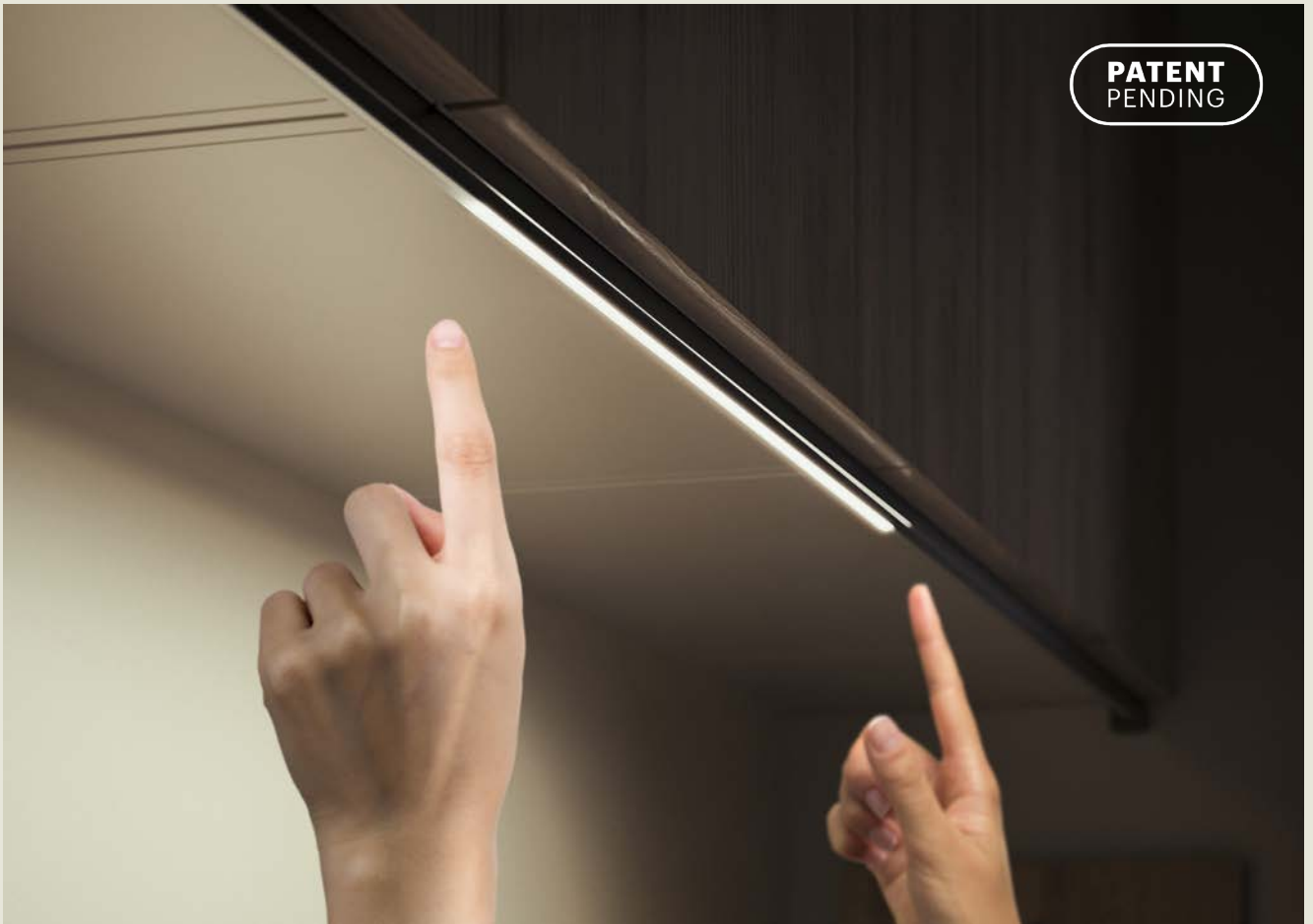





Infinito

Enhance your space

Functional and decorative solutions that create a welcoming atmosphere by highlighting the linearity of the kitchen

Infinito is a handlebar profiles serie with integrated linear lighting, designed to enhance handle-less furniture with targeted light accents that enhance the geometry of the shapes. A functional solution with great visual impact, to create customized atmospheres thanks to L&S Smart control systems and state of the art LED technologies. The profiles are made of anodized aluminum and available in the horizontal and vertical versions

IDEAL FOR

- kitchens
- handle-less furniture

FEATURES

- integrated lighting
- functional light that furnishes
- Smart control



INFINITO | ILLUMINATED VERTICAL HANDLEBAR

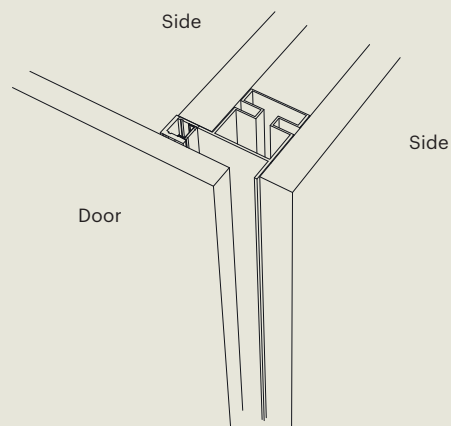
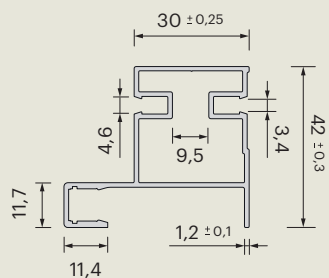

INFINITO | ILLUMINATED HORIZONTAL HANDLEBARS

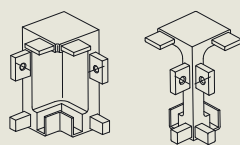
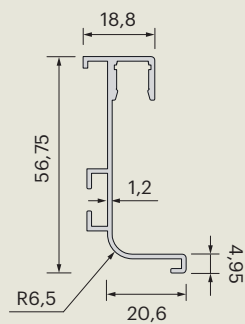

90° Corner
inner / outer

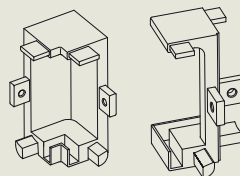
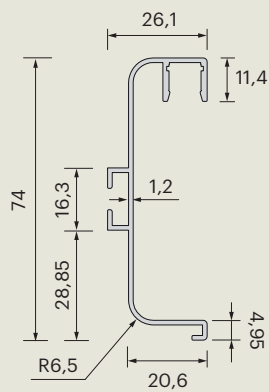

90° Corner
inner / outer

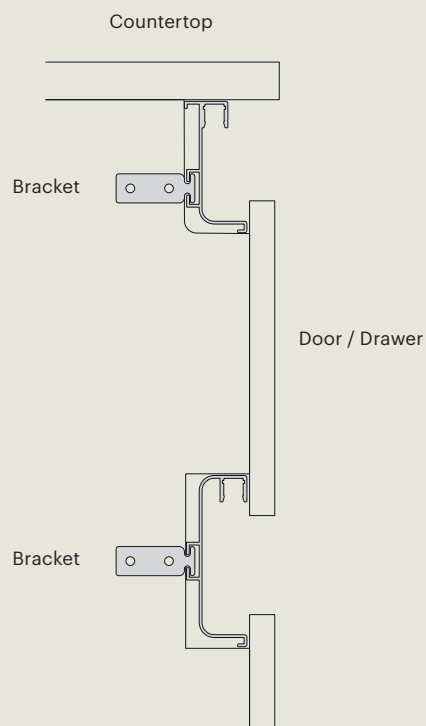



Moove



The free cut family

"Free cut" lamps collection,
customizable to the millimeter, to be
independently assembled

Moove is a versatile DIY lighting system, ideal for enhancing any furniture in an easy and intuitive way. The collection includes various aluminum profiles that can be cut to size, supplied in 3m lengths complete with a polycarbonate screen cover: each profile incorporates a new state of the art "free cut" LED strip, **which can be cut together with the profile at any point without cutting pitch constraints or loss of functionality**. A solution with no material wasting, in which each cut section can be used, by means of practical "plug&play" power connectors, to create customized lamps down to the millimeter with a "full light" effect without shadow areas.

IDEAL FOR

- Wardrobe cabinets
- Undercabinet
- Shelf

FEATURES

- "plug&play" system
- easy installation/
replacement
- cuttable to size
- integrated control



A complete range for every need

The Moove lamp collection includes various lighting solutions: a complete range of products to enhance furniture, for horizontal or vertical installation.

Moove 1 is a practical protruding profile, easy to install in any context without milling operations, ideal for refitting existing furniture; **Moove 2** is a small dimensions recessed profile with adjustable light beam, ideal for vertical installations inside the cabinet's sides; **Moove 3** is a versatile recessed profile, complete with various accessories for use in any environment; **Moove 4** is a flexible LED Reel for recessed installation, only 4mm wide



Plug & play power supply, integrated control and accessories

The cabled plug & play power connector, available for each Moove version, allows the creation of customized lamps in a simple, intuitive and safe way: a solution without the need to solder the LED that makes the installation of the device in the cabinet easier, also facilitating its possible replacement. The new integrated controls systems, functional and elegant, widen the lamp's installation scenarios, while the range of accessories allows the in-line connection of multiple lamp sections, an intelligent solution that avoids material waste



Preassembled Dual Color LED, "full light" without shadows

DIY lamps customized to the millimeter, with "full light" effect without shadow areas thanks to the pre-assembled LED Strip, cuttable at any point without loss of functionality together with the profile.

The color temperature varies from 2700K to 4000K by inverting the insertion side of the power connector or via remote light control systems

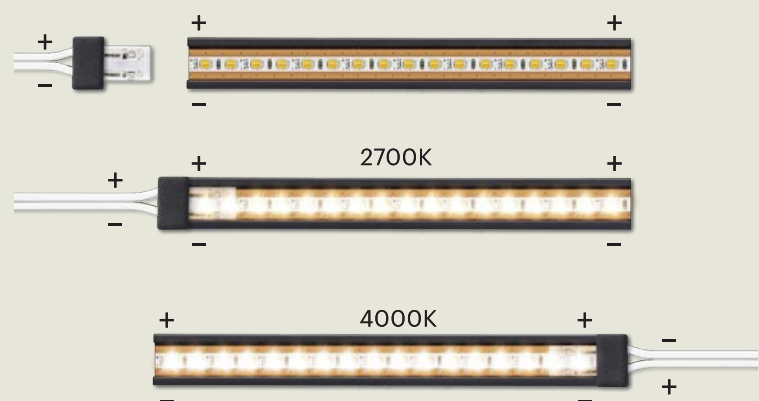

Cut, connect... create!

1.

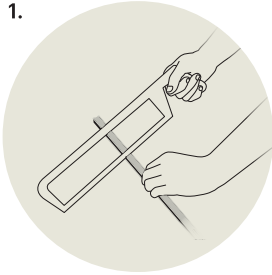

Cut the profile to size together with the screen cover

2.



Carefully remove any aluminum burrs, dust, debris or shavings

3.

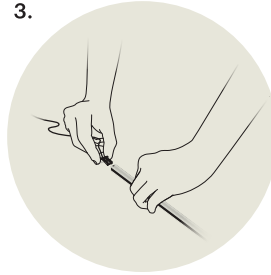

Use the plug & play Power Kit to assemble the lamp

4.

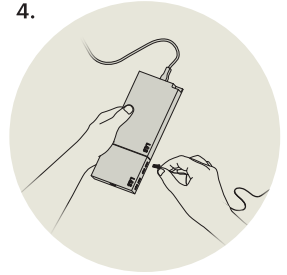

Connect MOOVE to the MEC Driver power supply system

Each cut section can be used to assemble customized lamps down to the millimeter

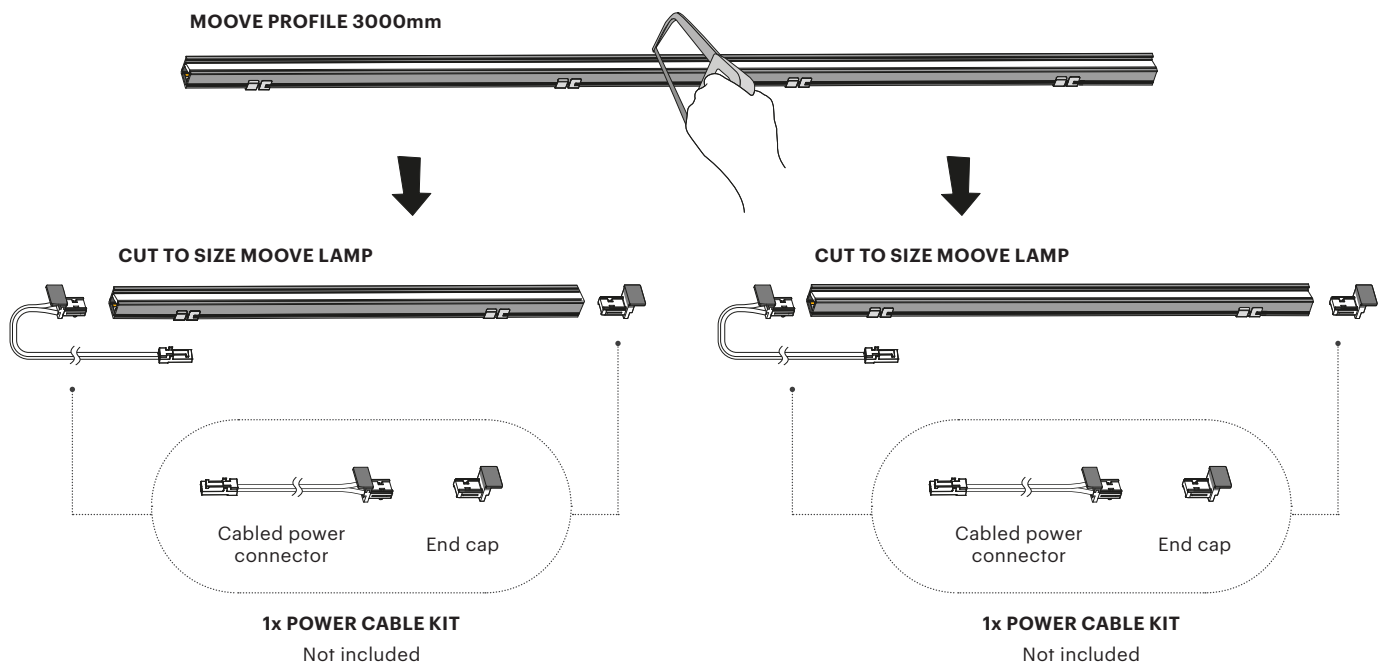

Note for cutting Moove profiles: use tools suitable for aluminum cutting and execute a precise and clean cut, carefully removing any aluminum burrs, dust, debris or shavings



Moove 1

SURFACE MOUNTED LAMP

- Direct light beam emission
- Complete range of Integrable plug & play sensors: IRS / PIR / Touch
- Accessories for in-line connection of multiple lamp segments
- Easy DIY installation, no furniture milling required, ideal for refitting and integration into existing furniture

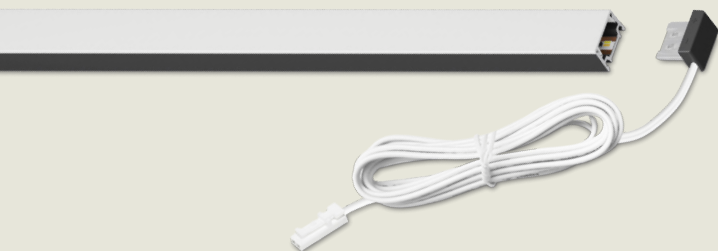
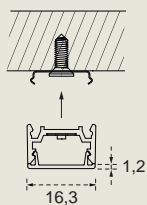



Moove 2

RECESSED MOUNTED LAMP

- Ideal for vertical installation inside the cabinet's sides
- Adjustable light beam orientation
- Retractable anti-glare screen cover
- Integrable plug & play IRS sensor
- Accessories for in-line connection

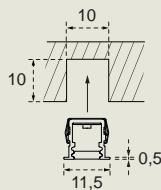



Moove 3

RECESSED MOUNTED LAMP

- Direct light beam emission
- Complete range of Integrable plug & play sensors: IRS / PIR / Touch
- Accessories for in-line connection of multiple lamp segments

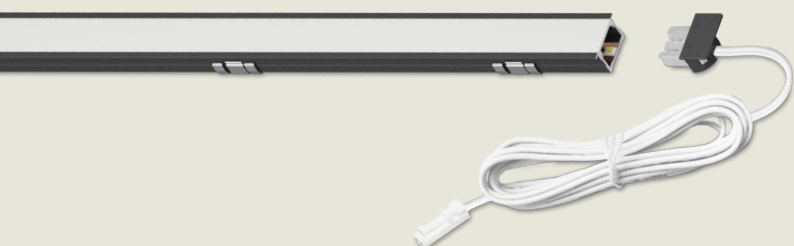
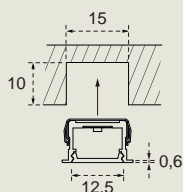



Moove 4

FLEXIBLE LED REEL

- Only 4mm wide
- Maximum flexibility in creating a variety of shapes
- Recessed installation

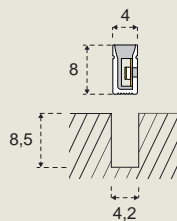

Micro 4

**PATENT
PENDING**

Very elegant



Slim, minimal and elegant

Micro 4 is a linear recessed lamp in opal polycarbonate, complete with a just 3 mm wide direct emission LED strip, available with Natural (4000K) or Warm (3000K) color temperatures. Thin and minimal, it is a luminaire that provides a very elegant lighting effect, easy to install thanks to the ergonomics of the profile which allows it to be inserted into the milled groove by pressure, without the need for fixing clips. Made exclusively to measure, it is a versatile lamp, ideal for illuminating the interior of tall units, wardrobes and cabinets with installation in the side panels, as well as shelves and shelves.

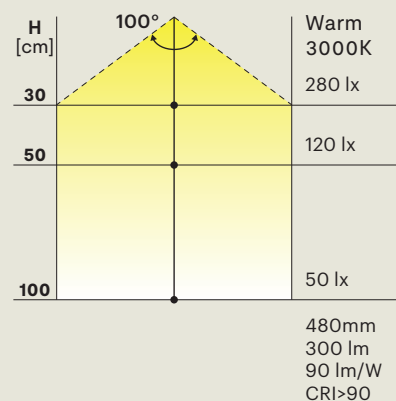

Micro 4

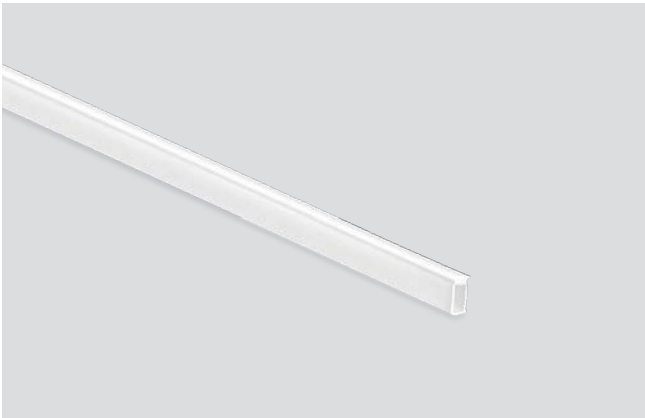

01 Opal

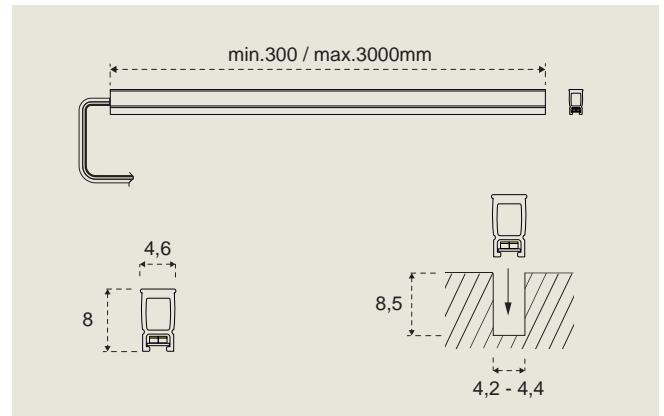

MICRO 4 - 24V DC	240 LEDs/m 3000K/4000K
on request	7W/m min.100 /max.3000mm

- Bespoke measures only, up to 3m
- Luminaire provided with 500 mm cable plus 2800 mm extension cable to the power supply

ACCESSORIES, POWER SUPPLY AND CONTROL

L&S DRIVER SYSTEM

MEC LITE and MEC Driver modular connection systems, for the power supply and control of 12V and 24V LED lamps



CONTROL SYSTEM

Complete range of wireless sensors and transmitters for remote control of LED lamps connected to L&S Driver System



Ivo X

Simply



Bespoke measures only: 100 mm ~ 3000 mm



Innovative and imperceptible

Ivo X is a linear recessed lamp with an innovative design, featuring extremely small dimensions which allow the installation of the luminaire **in a milled groove only 3mm wide**. Made exclusively to measure in coextruded polycarbonate (opaline / black), Ivo X traces an elegant light blade inside the furniture, so thin to be almost imperceptible. Ideal for lighting the interior of tall units, wardrobes and cabinets with installation in the side panels, it is available with a side-emitting LED light source in warm color temperature (3000K)

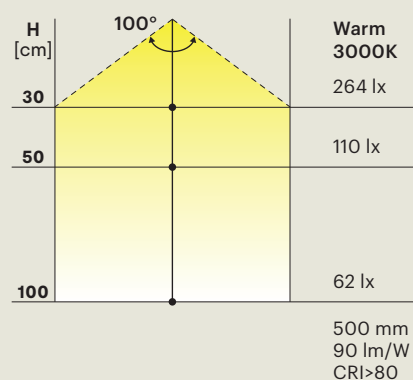

Ivo X



01 03 Coextruded Opal / Black

IVO X - 24V DC	180 LEDs/m 3000K
on request	10W/m min.100 /max.3000mm

- Bespoke measures only, up to 3m

ACCESSORIES, POWER SUPPLY AND CONTROL

L&S DRIVER SYSTEM

MEC LITE and MEC Driver modular connection systems, for the power supply and control of 12V and 24V LED lamps



CONTROL SYSTEM

Complete range of wireless sensors and transmitters for remote control of LED lamps connected to L&S Driver System

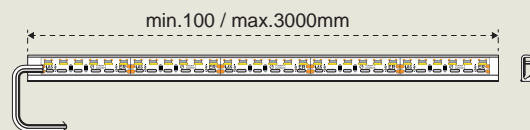
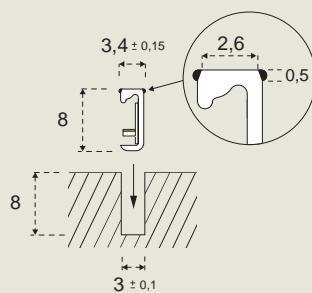

Focus

Giuseppe Bavuso Design

Eye catching



The functionality of an adjustable spotlight in a miniaturized design

Focus is a collection of handy adjustable recessed spotlights with an exclusive and miniaturized design, available in elegant black finish with round or square design, in single or double LED versions. All Focus spotlights provide uniform and comfortable lighting and fit within niches, display cases or bookcases in any residential or commercial environment. The LED light source is available with warm color temperature (3000K).

Focus

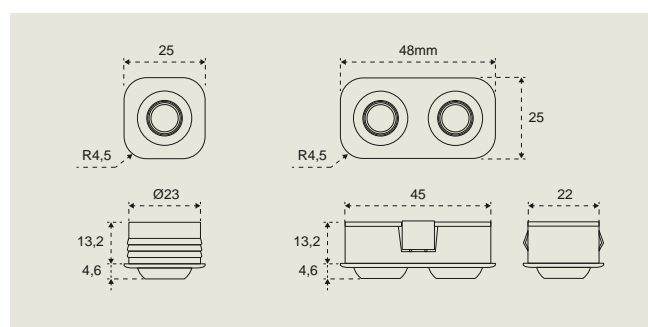
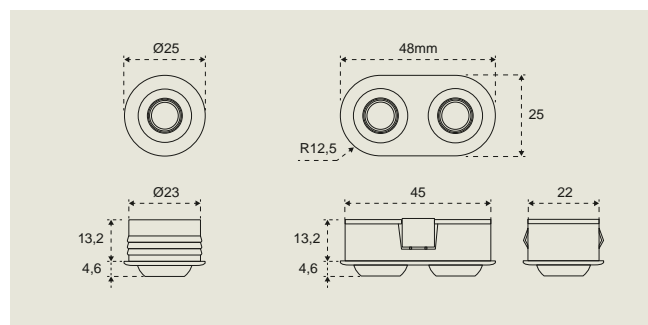

03 Black

FOCUS - 24V DC

03

528300001	1W	ROUND - SINGLE	3000K
528300003	1,8W	ROUND - DOUBLE	3000K
528300002	1W	SQUARE - SINGLE	3000K
528300004	1,8W	SQUARE - DOUBLE	3000K

Each spotlight is provided with 500 mm cable plus 2800 mm extension cable to the power supply

ACCESSORIES, POWER SUPPLY AND CONTROL

L&S DRIVER SYSTEM

MEC LITE and MEC Driver modular connection systems, for the power supply and control of 12V and 24V LED lamps



CONTROL SYSTEM

Complete range of wireless sensors and transmitters for remote control of LED lamps connected to L&S Driver System



Cora

CE UK
CA

Round



Iconic and exclusive

Cora is a recessed spotlight with an exclusive and elegant design, featured by a perimeter light that guarantees homogeneous light flux and no visible LEDs. Ideal for undercabinet, on shelf or inside niches and bookcases installation, Cora is available with Emotion light source, which allows colour temperatures variations from Warm White (2700K) to Cold White (6500K). The frontal cover is available in two different finish: black and stainless steel

H [cm]		Emotion 2700K	Emotion 6500K
30		618 lx	649 lx
50		212 lx	229 lx
100		62 lx	68 lx
		159 lm 64 lm/W CRI>80	164 lm 65 lm/W CRI>80

Cora



90 Stainless steel 03 Black

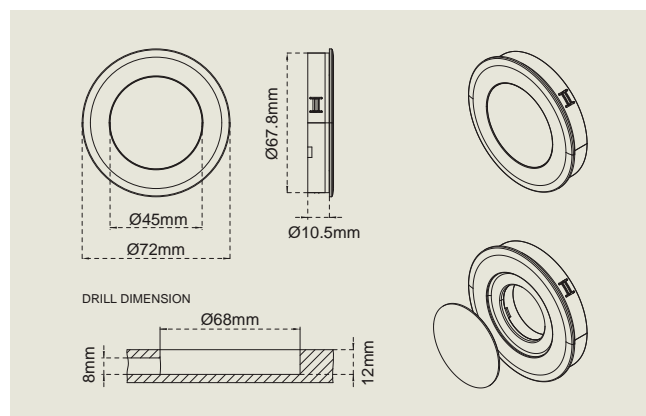

CORA - EMOTION - 12V DC

03 90	545700001	2,5W	Ø 68mm	2700K÷6500K
-------	-----------	------	--------	-------------

ACCESSORIES, POWER SUPPLY AND CONTROL

EMOTION

Colour temperature variation from 'warm' to 'natural' white (3000-4000K).



L&S DRIVER SYSTEM

MEC LITE and MEC Driver modular connection systems, for the power supply and control of 12V and 24V LED lamps



CONTROL SYSTEM

Complete range of wireless sensors and transmitters for remote control of LED lamps connected to L&S Driver System



Zebra

CE UK
CA

Thinny light panel

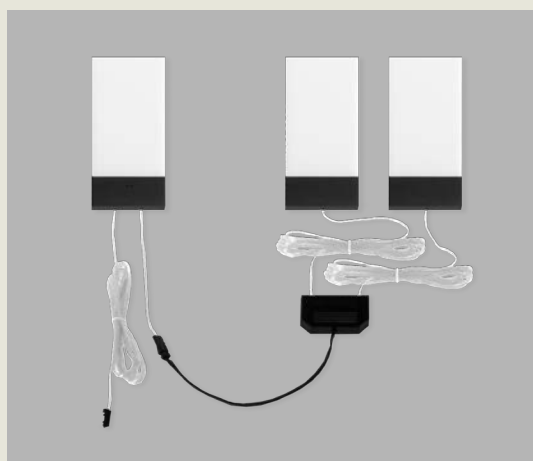

Versatility with reduced thickness

Zebra is a rectangular spot designed to get a homogeneous light flux, to resemble a miniature light panel. The reduced thickness makes Zebra the ideal solution for undercabinet lighting, as well as other applications. The version with integrated switch (IRS) can either be controlled independently or used to control a series of connected spots. Easy mounting by means of a hidden bracket, which is covered by the black section of the spot: the main body mounts to this part magnetically.

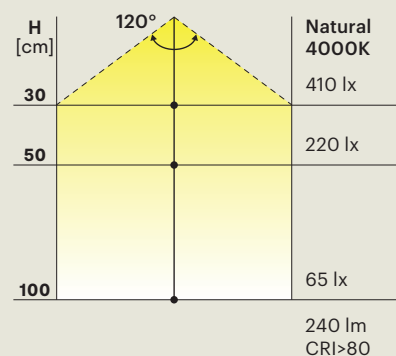

Zebra



03 Black

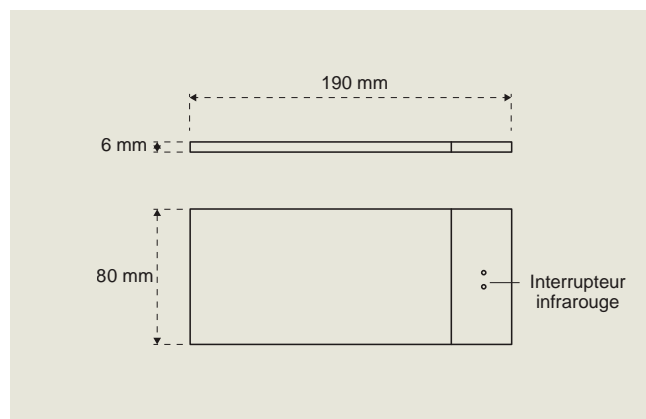

ZEBRA - 12V DC - IRS

03	666893	2,2W	190x80mm	4000K
----	--------	------	----------	-------

ACCESSORIES, POWER SUPPLY AND CONTROL

IRS SENSOR

Fast movement for switching on and off.



L&S DRIVER SYSTEM

MEC LITE and MEC Driver modular connection systems, for the power supply and control of 12V and 24V LED lamps



ZEBRA - 12V DC

03	666886	2,2W	190x80mm	4000K
----	--------	------	----------	-------

Without switch

ACCESSORIES, POWER SUPPLY AND CONTROL

L&S DRIVER SYSTEM

MEC LITE and MEC Driver modular connection systems, for the power supply and control of 12V and 24V LED lamps



CONTROL SYSTEM

Complete range of wireless sensors and transmitters for remote control of LED lamps connected to L&S Driver System





MEC *LITE*



Ready-to-light

The innovative "Plug&Play" power supplies platform MEC Driver by L&S expands with the introduction of **MEC *LITE***, the new **"Ready-to-light"** power supply and control system for LED lamps.

MEC *LITE* is a multi-certified product with a compact and modular design: equipped with an integrated power distributor, it is **versatile, straightforward and easy to install**. It also includes new intuitive **Smart Home** solutions for light customization and an innovative range of dedicated wireless sensors and transmitters.

MEC *LITE* ensures **greater energy efficiency** compared to the MEC Driver product range in the catalog, with which it is 100% compatible.

Ready-to-light

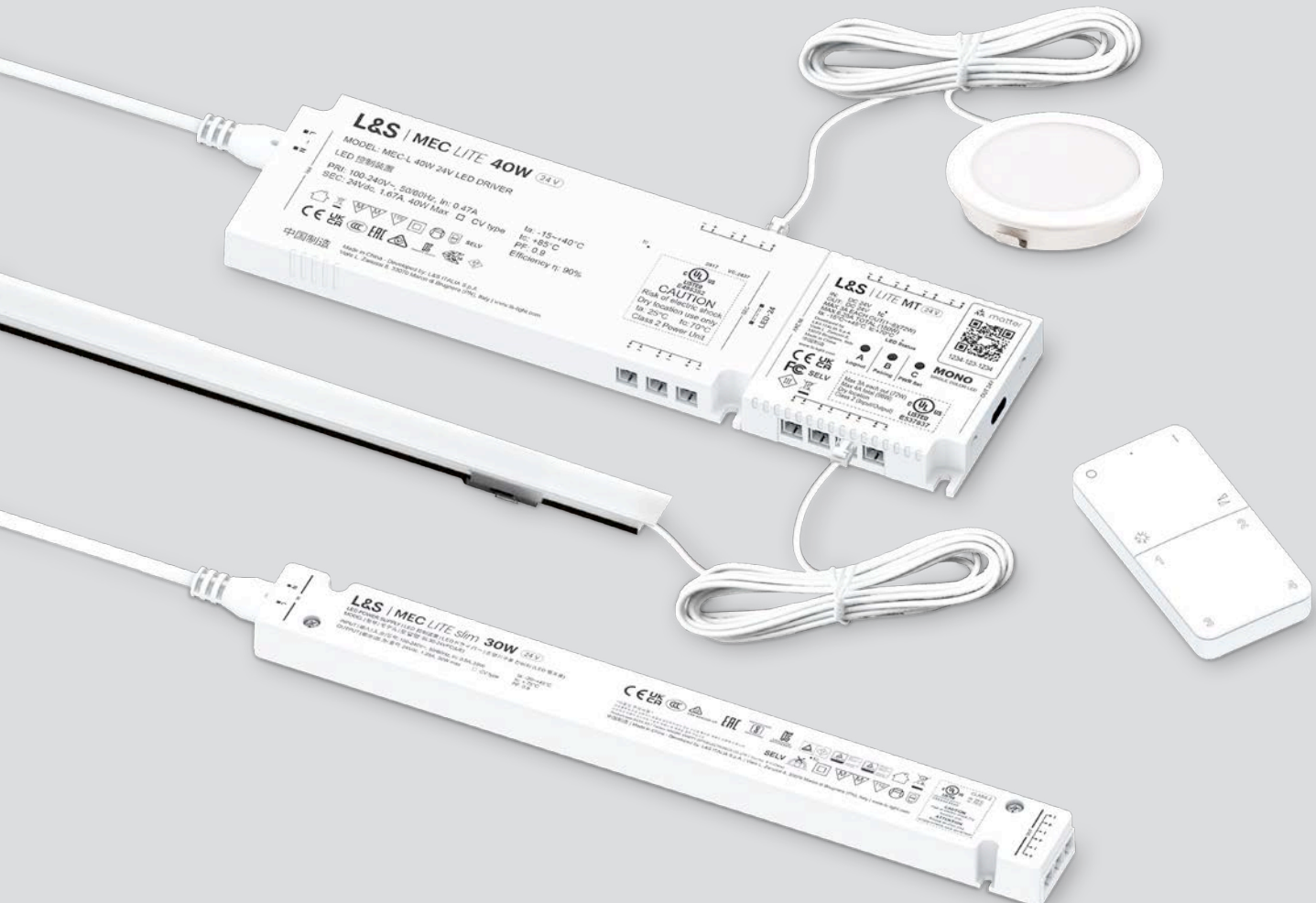

Practical integrated power distributor

The integrated power distributor of **MEC LITE**, with an optimized number of outputs based on the power supply's capacity, is a practical and easy-to-use solution for quickly connecting LED lamps without additional distribution modules, which can still be used if it becomes necessary to power a larger number of lamps.

Reduced width for special installations

The new **MEC LITE slim** model, equipped with an integrated 3-output distributor, is thin and versatile, making it ideal for installation in tight spaces. Available exclusively in 24V, it can be connected to the control modules from the L&S power supply range via dedicated cable.

New control modules: Easier Smart Home

MEC LITE features a modular design with new Smart Home solutions for light control via voice assistant or smartphone, allowing for endless customizations in a simple and intuitive manner. **LITE MT**, the module based on the Matter protocol, connects directly to the native app of the most popular Smart Home devices (eliminating the issue of managing different apps and protocols). The Bluetooth module **LITE BT** provides simple and immediate light management at your smartphone's fingertips; the **Zigbee** Module ensures quick and precise lighting control in a reliable low-energy consumption mesh network

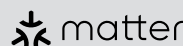

Wireless control, practical and elegant

The new radio frequency transmitters make light management easy and incredibly versatile. **LITE sensor** is an innovative all-in-one sensor suitable for any context, usable as a motion sensor, door contact sensor, or touch transmitter. **LITE remote** is a practical 4-channel transmitter that allows control of multiple **LITE** control modules and can be installed on the wall using a practical magnetic support.



LITE sensor



LITE remote

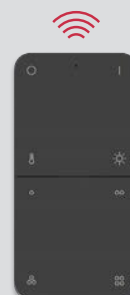

4 channel remote

Multi-certified for global use

MEC LITE meets all major quality and safety requirements imposed by various global regulatory standards. The certifications obtained, together with the Wide Input system of 100-240 V AC and a separate power cable that can be chosen based on the type of plug used, make **MEC LITE** a global, safe, and reliable product.

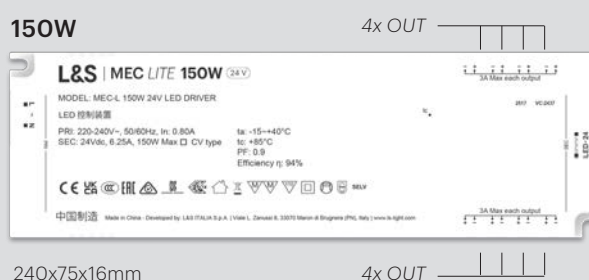
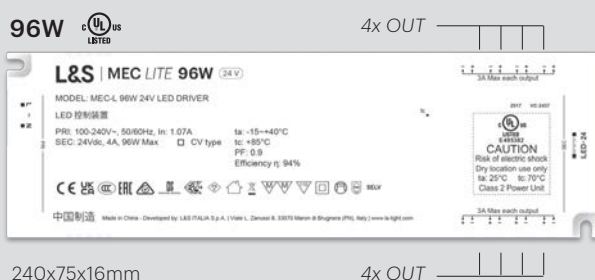
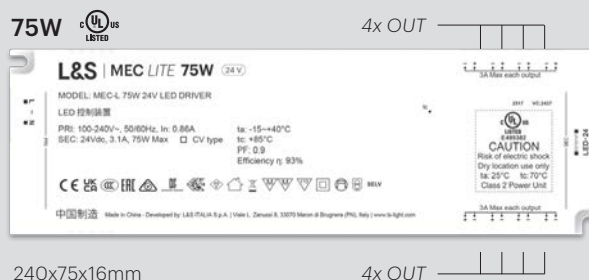
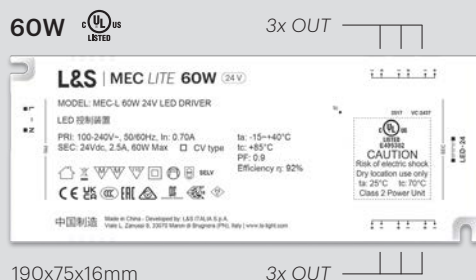
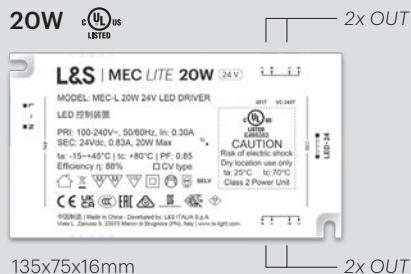

MEC LITE 24 V

PATENT
PENDING

MEC LITE 12 V

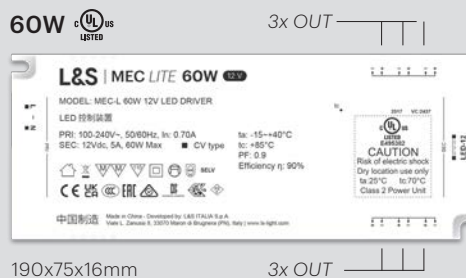
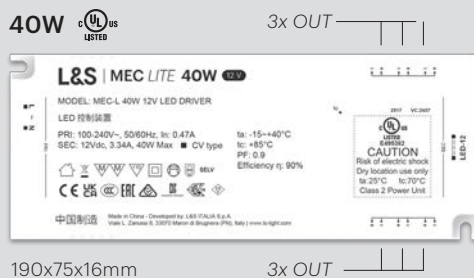
PATENT
PENDING

Smart Control

Easier light customization with new control solutions, compatible with the most popular Smart Home management platforms.
Choose the configuration that best suits your needs

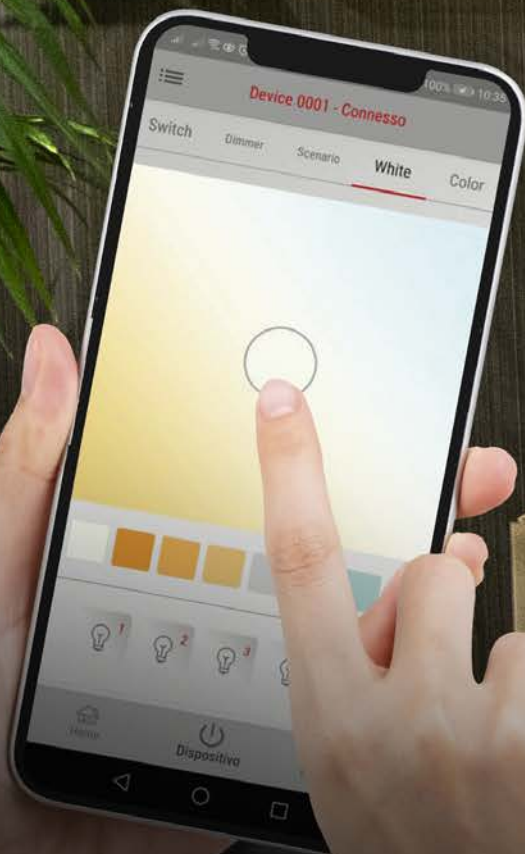

Amazon Alexa is a registered trademark of Amazon Inc.
Apple Home Kit is a registered trademark of Apple Inc.
Philips Hue is a registered trademark of Koninklijke Philips N.V



The universal standard for Smart Home devices

It simplifies the connection between smart devices from different brands through the innovative, fast, and reliable Matter protocol: the **LiteMT control module connects directly to the native app of Smart Home devices** (e.g., Amazon Alexa, SmartThings, Apple HomeKit). Through the Wi-Fi network, the device can be controlled from anywhere in the house. Control and customization of lighting through **voice assistants and smartphones**: intuitive and suitable even for non-expert users, thanks to an easy and immediate setup process that involves simply scanning the QR code present on the module.

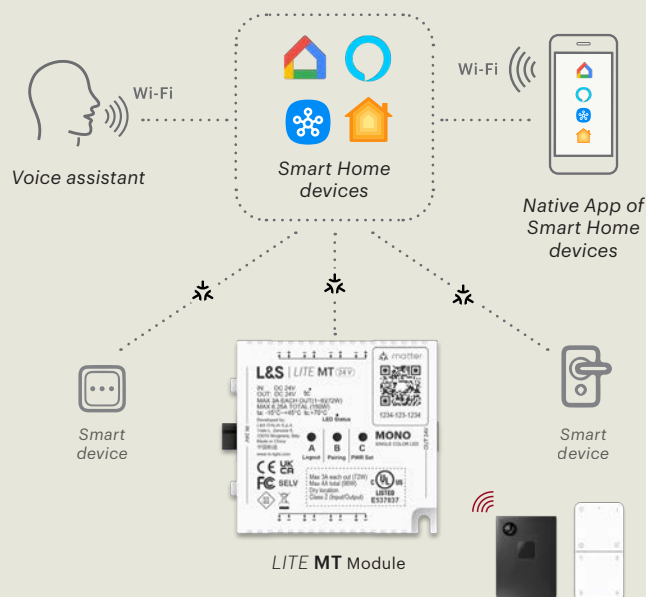

Low power consumption wireless protocol

With the new **ZigBee** control module, our lighting devices **communicate with other smart home devices** (e.g., plugs, locks, and smart bulbs) **through a compatible bridge** (e.g., Philips Hue) in a reliable low-energy consumption mesh network. **Quick and precise control of lighting via smartphone** using the native app of the bridge or through voice assistants compatible with the ZigBee 3.0 protocol.

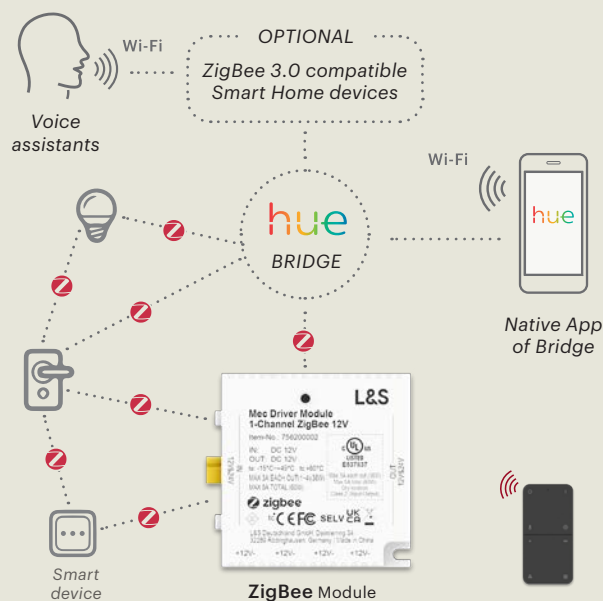

The solution for smartphones simple and accessible

The most well-known and familiar technology, now with the new LiteBT module, allows for the integration of our devices into the smart management of the home: **through the dedicated app developed by L&S, light management is simple and immediate.** Customized lighting, intensity adjustment, and real-time lighting scenes are just **a tap away on your smartphone.**

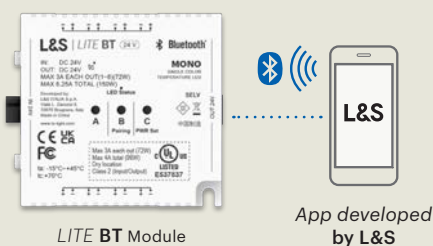

L&S Driver system (24 V)



MEC LITE (24 V)



MEC LITE slim (24 V)



MEC Driver (24 V)

LITE MT (24 V)



LITE BT (24 V)

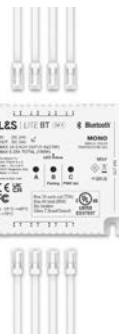

matter

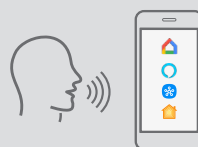

Voice Assistants and App
for the Smart Home Device

Bluetooth™



Dedicated App
L&S

L&S Driver system (12 V)



MEC LITE (12 V)



MEC Driver (12 V)



LITE sensor



LITE remote

ZigBee Module (24 V)

1 channel

4 channels



Sensor Module (24 V)



RGBW Module (24 V)

1 channel



Native smartphone app for the BRIDGE device
optional voice assistant



CABLED sensors



RGB / Emotion
remote



4 channel
remote

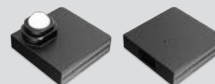

WIRELESS sensors

ZigBee Module (12 V)

1 channel

4 channels



Sensor Module (12 V)

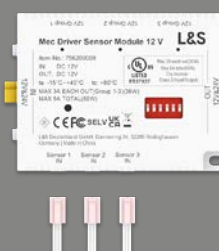



LED Technologies

A new wide choice
of 24V LED Strips
to be integrated
in all our solutions

Easy and versatile solutions to create lighting systems for every needs

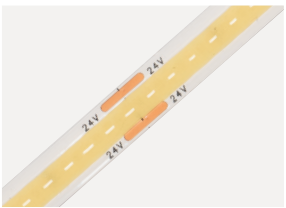
- Cuttable to size
- Practical and easy to use thanks to reel-to-reel connection cables
- No welding required
- High Color Rendering Index

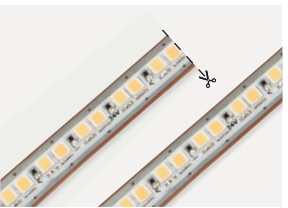
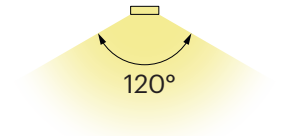
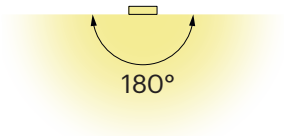
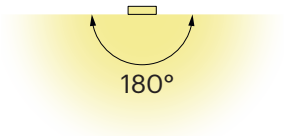
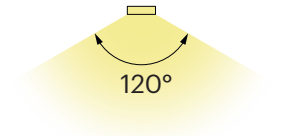
	HE Strip. High efficiency LED strips More light output, less energy input.	COB. Chip on Board LED strips Continuous light effect with deceiving aesthetic.	Lumitough®. LED strips High robust quality, long lifetime, Consistent color. Ideal for small fragile spaces, high temperatures, humidity, rough handling during production process.	Free cut. LED strips High-performance LED strip without modules. Profile, cover, and strip can be cut together at any point, with no pitch constraints and no loss of functionality.
TECHNOLOGY				
BEAM ANGLE				
APPLICATION FLEXIBILITY	Less flexible and versatile	More versatile and flexible	More versatile and flexible (distortion 720°)	Less flexible and versatile
CRI	>80	>90	>90	>90

Accessories

73	Laser door back
74	IR tube D8
75	mini IR
76	Spider plus



LASER DOOR BACK

DOOR SENSOR (24 V)

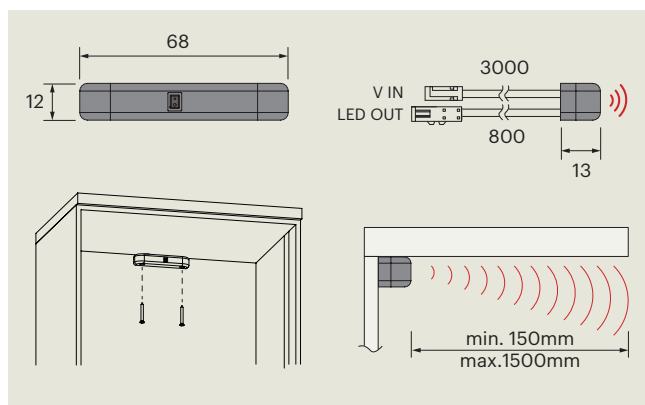

CONTROL SYSTEM FOR LED LAMPS

ON-OFF / Color Temperature

Control system complete with laser sensor for door opening detection. Works with furniture doors of any material (including glass), type (single, double, flap), finish or colour. Available in MONO (single color LED) or EDC (dual color LED) version.

SPECS

- V IN/OUT: 24V DC (MAX 2A - 48W)
- Detection distance (min/max): 150 / 1500mm
- Surface mounting against furniture backrest by means of fixing screws (included)
- Self calibration (10 sec.) of the system upon first Driver connection (with furniture door closed)
- Cable exit upwards or towards the back
- Cable hole: Ø10mm

FUNCTIONS

- ON/OFF (soft start)
- Color temperature change (EDC version only): quickly open and close the door for 3 consecutive times to change the color temperature of the connected EDC lamps

WAYS	V IN/OUT	MAX LOAD	LED	CODE
1 WAY	(24 V) DC	2A / 48W	MONO	941300095
			EDC	941300096

6 WAY DISTRIBUTION BOX (included)

To connect up to 6 LED Lamps to LASER DOOR BACK

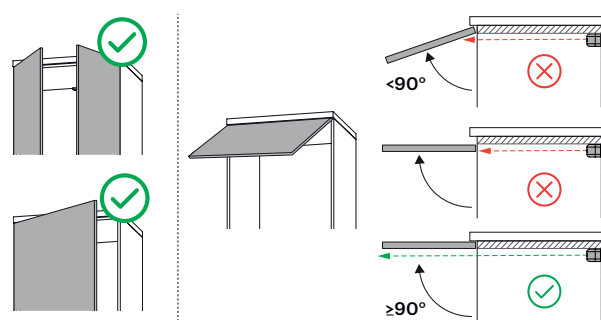
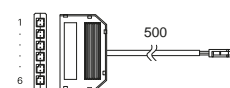

Direct connection to LED Driver (not included) exclusively via power distributor

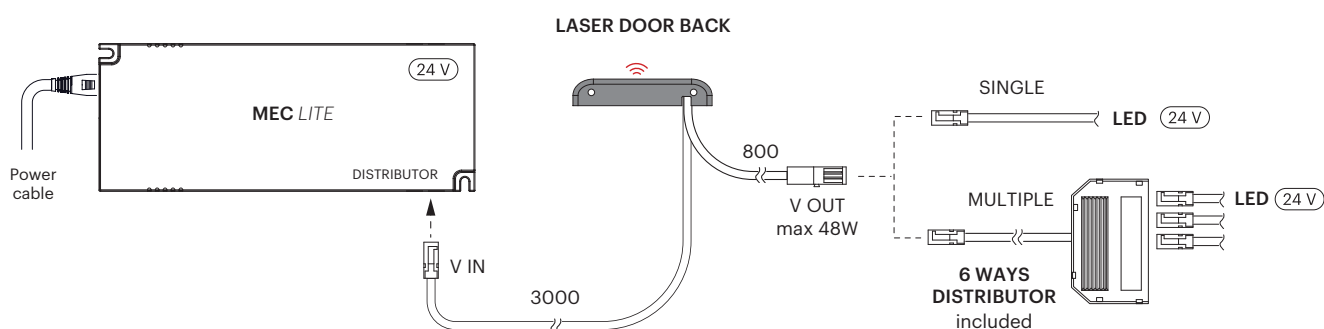

IR TUBE D8

DOOR SENSOR (24 V)

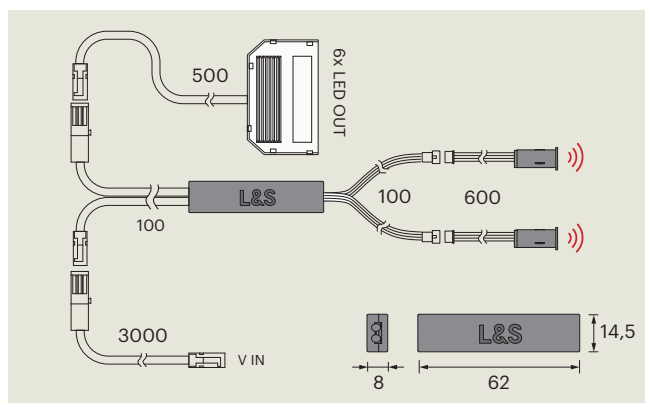

DOOR CONTACT SWITCH ON-OFF

Control system with n°2 cabled IR Door Sensors for recessed mounting (hole: Ø8mm).

- Accensione soft start (3 sec.)
- Auto OFF 10 min.

WAYS	V IN/OUT	MAX LOAD	SENSOR N°	CODE
1 way	24V DC	3A / 72W	1 SENSOR	on request
			2 SENSORS	on request

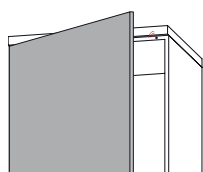

1 SENSOR

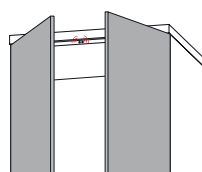
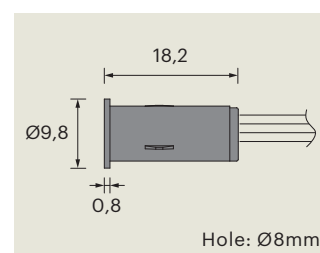
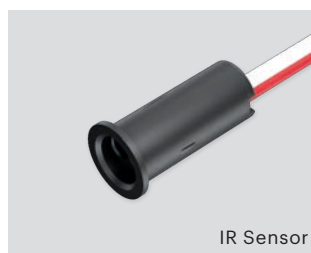

2 SENSORS

Direct connection to LED Driver (not included) exclusively via power distributor

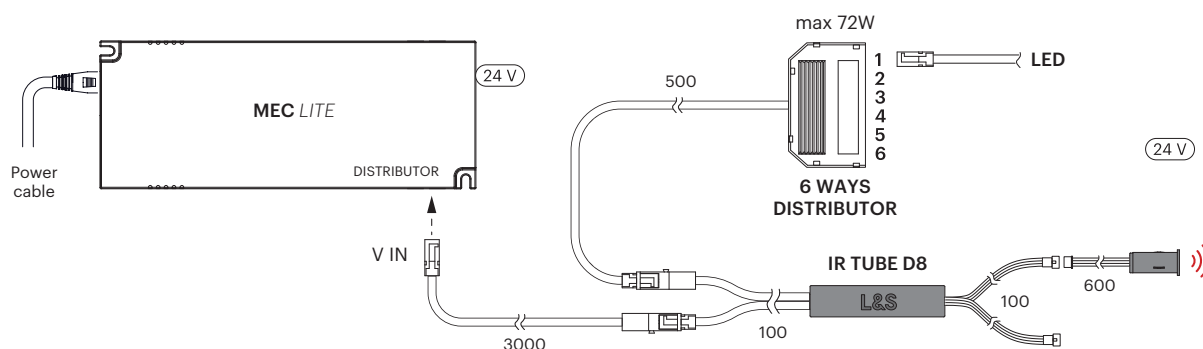

mini IR

SENSOR SWITCH 12 V / 24 V

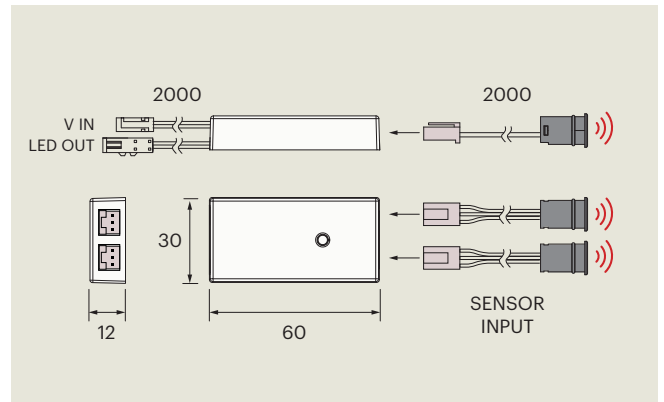

LED CONTROL UNIT WITH WIRED IR SENSORS

ON-OFF / Dimmer

Control unit with n°2 cabled IR Sensors for recessed mounting (hole: Ø10mm). Two operating modes (selection via button on the control unit):

MODE 1

Proximity sensor (touchless switch)

ON/OFF

DIMMER

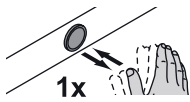

MODE 2

Door contact ON/OFF (auto OFF 10 min.)

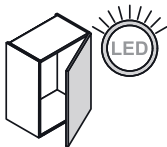
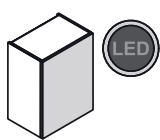

WAYS	V IN/OUT	MAX LOAD	SENSOR N°	CODE
1 way	24V DC	3A / 72W	1 SENSOR	600000017
			2 SENSORS	600000018



IR Sensor

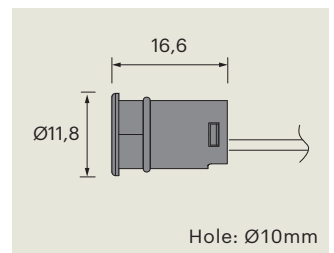

Hole: Ø10mm

SURFACE MOUNTED HOUSING

Optional IR Sensor housing

CODE

943900004



Direct connection to LED Driver (not included) exclusively via power distributor

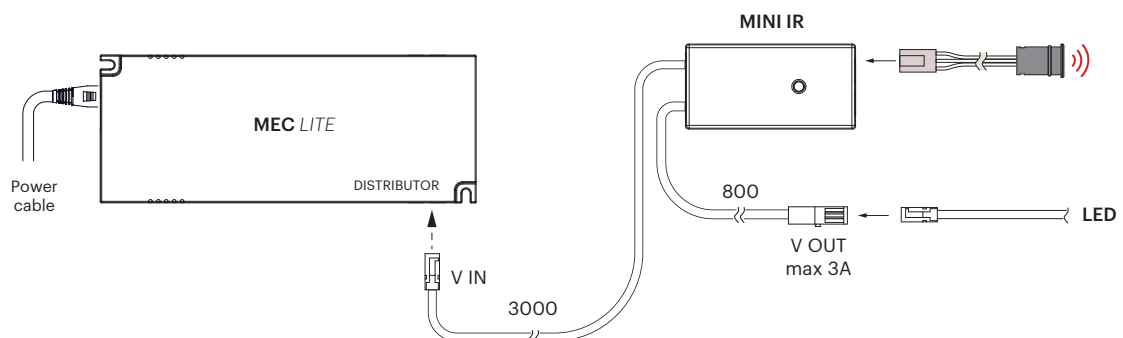

SPIDER PLUS DOOR SENSOR (24 V)

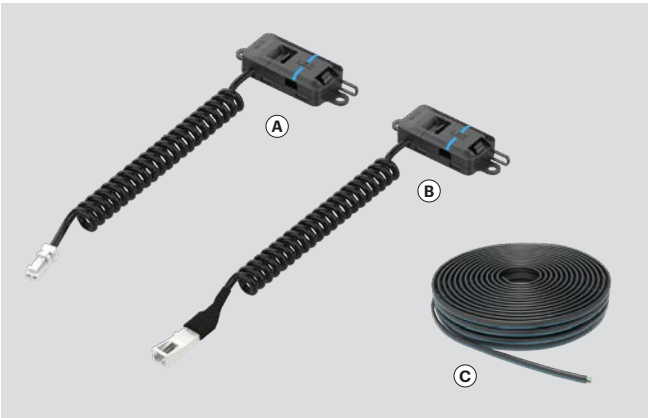

POWER DISTRIBUTOR FOR LED LAMPS

Spider Plus is an intuitive and easy-to-use solution that simplifies wiring management of cabinet installed lamps installed: the system uses practical piercing connectors with spiral cable (A/B), freely positionable along a cuttable to size power line (C) connected to the Driver. Fully self customizable in safety, Spider Plus is a clever product that allows maximum versatility and adaptation to every need, usable, connected to a control module, even with the remote control solutions of L&S

V IN/OUT	MAX LOAD		CODE
(24 V) DC	3A / 72W	(A) Connector to Driver	on request
		(B) Lamp connector	
12 V DC	3A / 36W	(A) Connector to Driver	
		(B) Lamp connector	
		(C) Cutable to size 2 Poles cable - 5000mm	

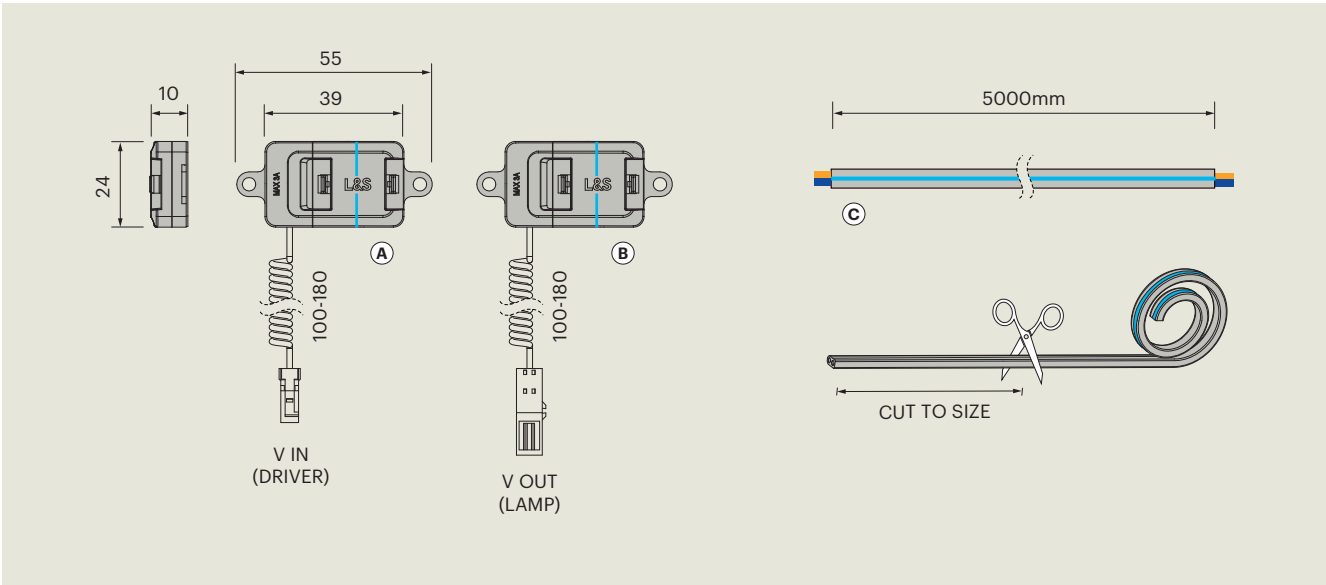

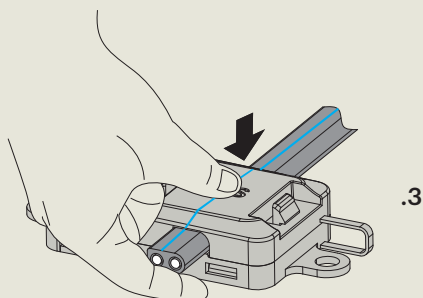
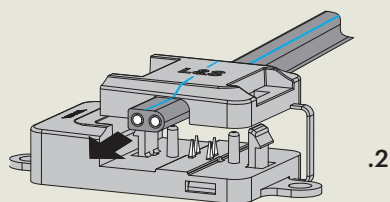
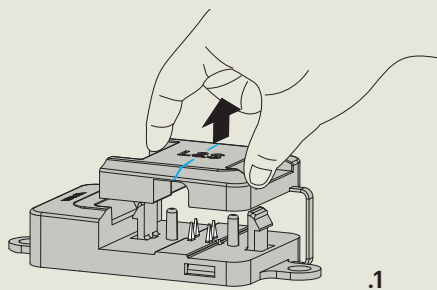
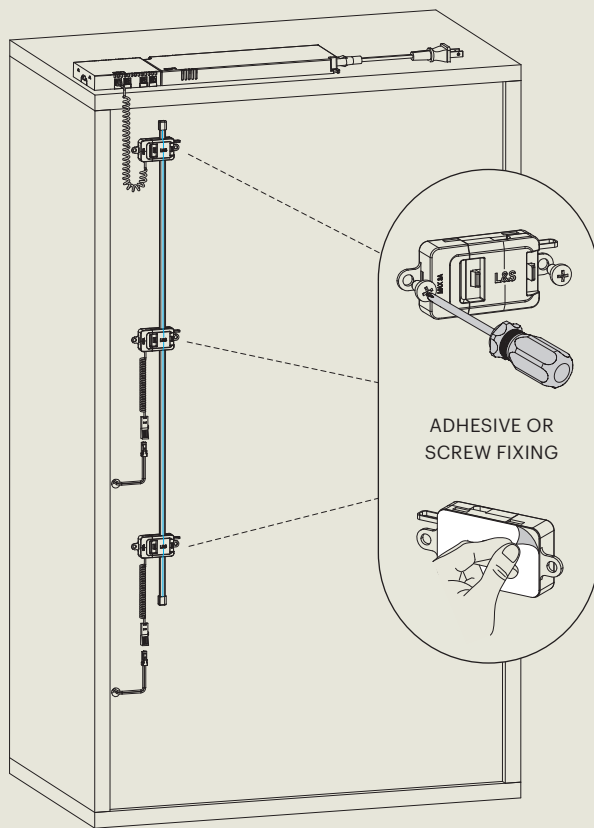

LED DRIVER
(not included)



LAMP CABLE



LAMP CABLE



CAP

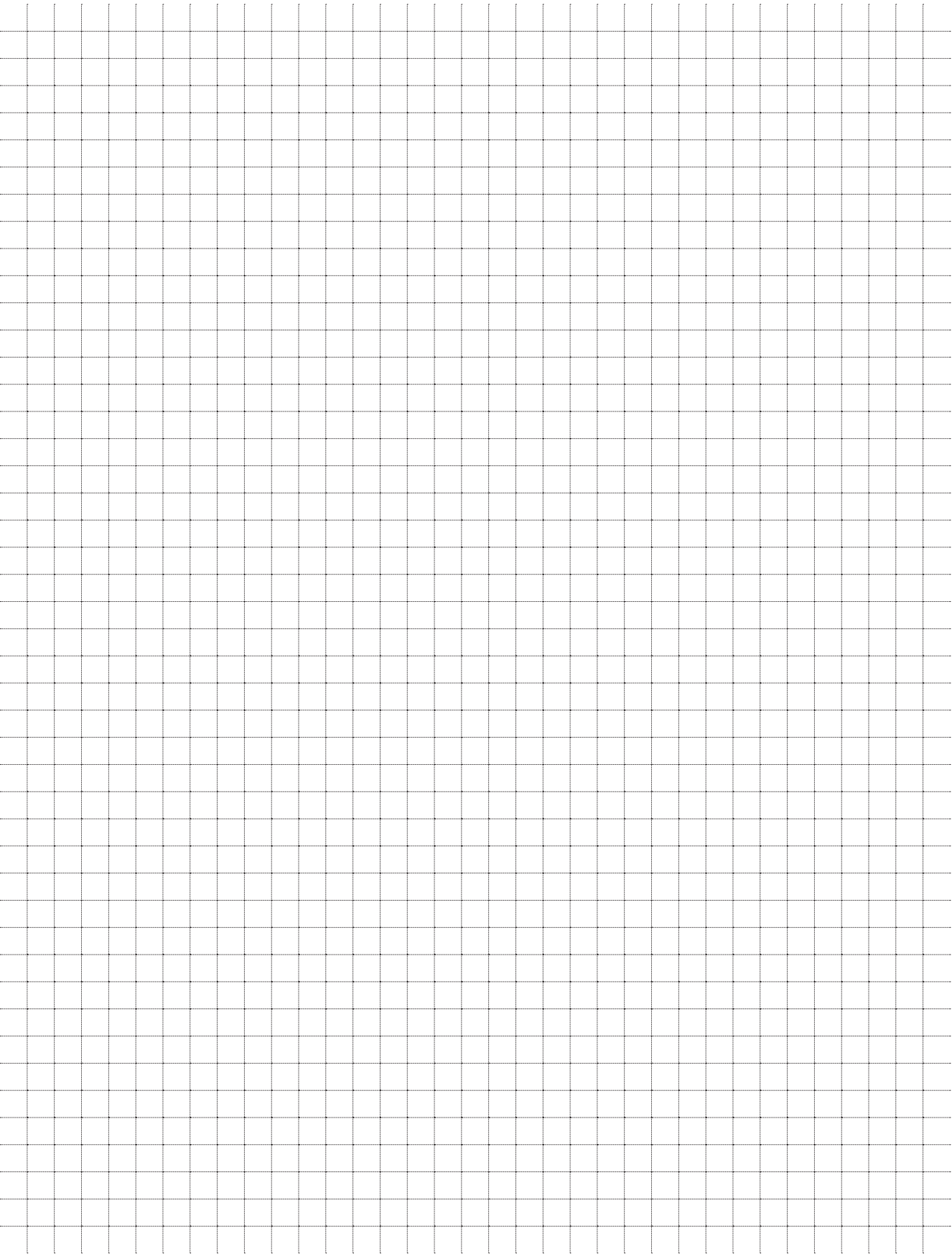

The information present in this catalog may be subject to errors. The articles, their characteristics, data and dimensions found therein are not binding and may be subject to change without prior notice from the company.

HEADQUARTERS

OUR SUBSIDIARIES

ITALY

Brugnera
Via L. Zanussi, 8
Maron di Brugnera (PN)
+39 0434 616611
info@ls-light.com

Varese
Via Pacinotti, 54
Varese (VA)
+39 0332 491247
info@formaefunzione.com

Tavullia
Via del Lavoro, 4
Tavullia (PU)
+39 0721 901123
info@italpek.it

Recanati
Via Armando Cingolani, 13
Zona Ind.le P.I.P.
Sambucheto di Recanati
Recanati (MC)
+39 071 0960086
sales@fluxitalia.com

GERMANY

L&S Deutschland GmbH
Daimlerring, 34
Rödinghausen
+49 5223 8790-0
info@ls-light.de

CHINA

LS Lighting Equipment
(Shanghai) Co., Ltd.
No. 255, LongPan Rd.,
Malu Town,
Jiading District, Shanghai
+86 021 69 15 67 91
info.china@ls-light.com

UNITED STATES

L&S Lighting Corporation
1505 Pavilion Place, Suite A
Norcross, Georgia
+1 877 877 0757
info.us@ls-light.com

LS-LIGHT.COM