

# Hi Line

MODULAR SYSTEMS

HORIZONTAL WALL  
PANELLING SYSTEM  
WITH COMBINING  
LIGHTINGS



**L&S** Lighting  
Intelligence



# Hi Line

---

## MODULAR SYSTEMS

---

HORIZONTAL WALL  
PANELLING SYSTEM  
WITH COMBINING  
LIGHTING

# Hi Line

**PATENT  
PENDING**

The electrification system for horizontal paneling that integrates linear lighting, creating blades of diffused light with great visual impact

The structural aluminum profiles conceal a practical track electrification system that allows for the integration of elegant aluminum shelves with built-in lighting into the paneling. This is an aesthetic and functional solution that eliminates the need for visible cables and simplifies the installation process.

Hi Line is a customizable and versatile system that enhances living and exhibition spaces with the option to integrate aluminum storage modules, linear lighting, or Solaris light panels to create captivating light effects.

---

**IDEAL FOR**

- every residential environment
- retail

**FEATURES**

- modular and versatile
- easy installation
- cable-free electrification of shelves
- decorative lighting and furniture element



## Component schedule

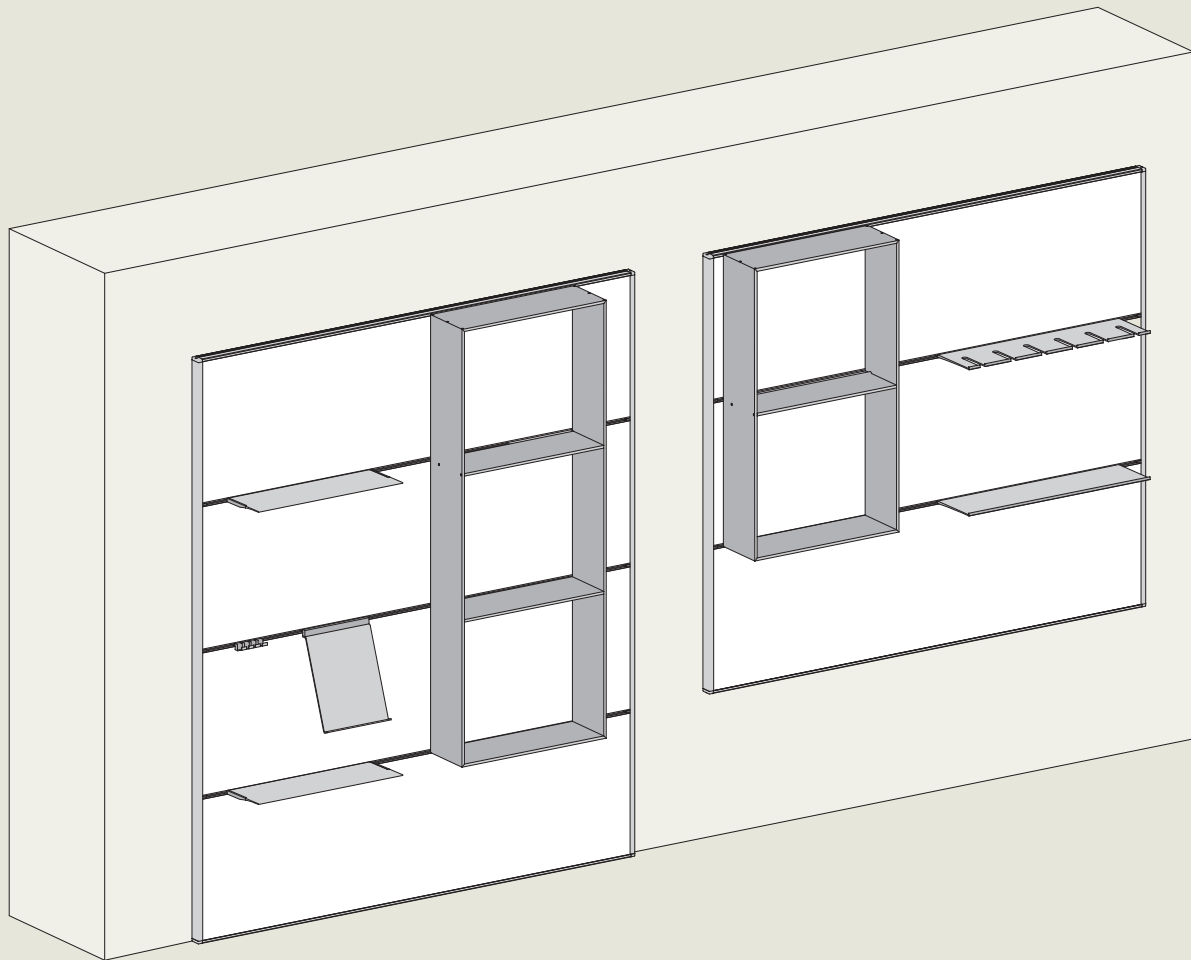

The Hi Line system allows the configuration of electrified structures for horizontal wall-paneling, enabling the wireless integration of light fixtures and aluminium accessories. The modular electrified structure can be installed as either a floor-mounted or suspended element and can be integrated with upper or lower linear wall-washer lighting.

**Hi Line Hi Line is compatible for use with 19mm wooden back panels (by the furniture maker)**

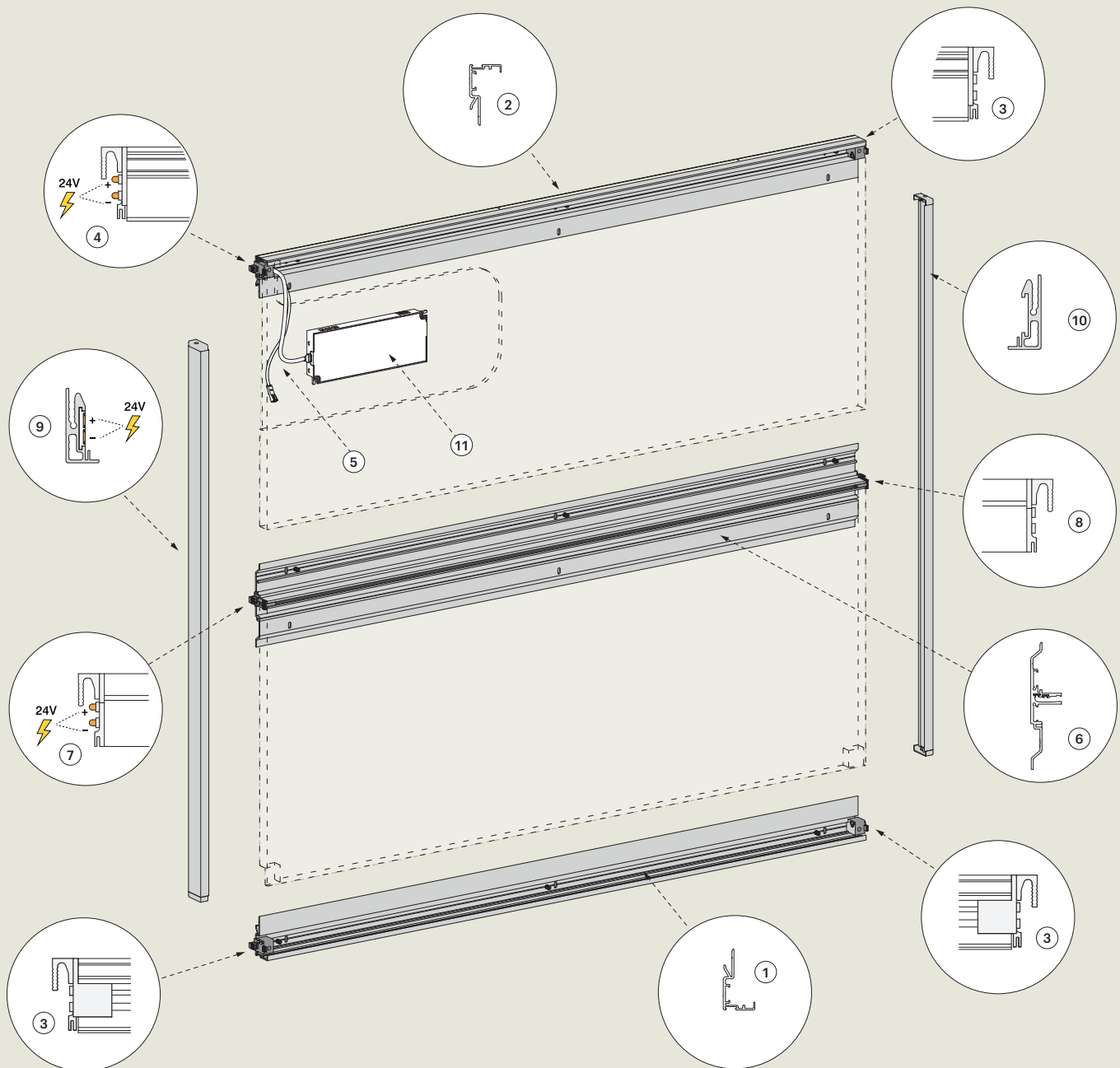

1. Lower closing profile
2. Upper closing profile (**electrified**)
3. Side profile mounting bracket, installed on closing profile
4. **Cabled electrified** side profile mounting bracket, installed on closing profile
5. **Electrified** mounting bracket wiring
6. Rear profile, **electrified**, complete with concealed conductive tracks

7. **Electrified** side profile mounting bracket, installed on rear profile
8. Side profile mounting bracket, installed on rear profile
9. **Electrified** side profile, complete with concealed conductive tracks
10. Side profile
11. LED Driver (not included)
12. Wooden back panel (by the furniture maker)

# Aluminium structural profiles

03 Black

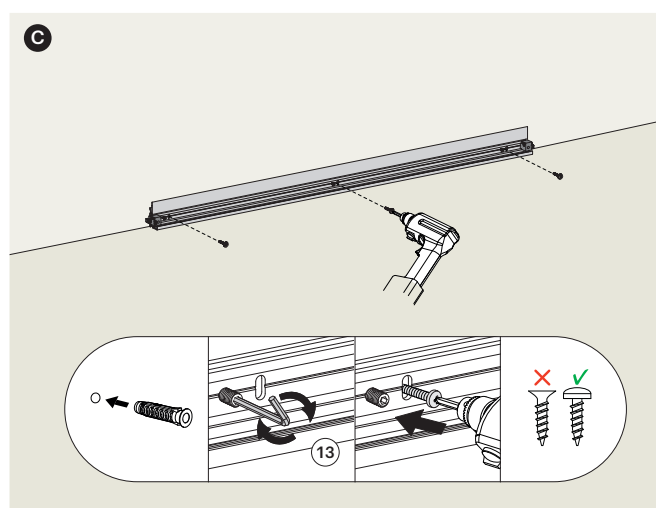
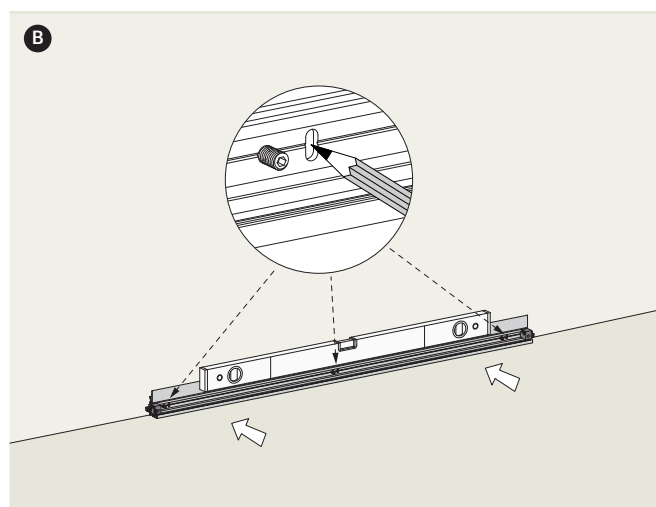
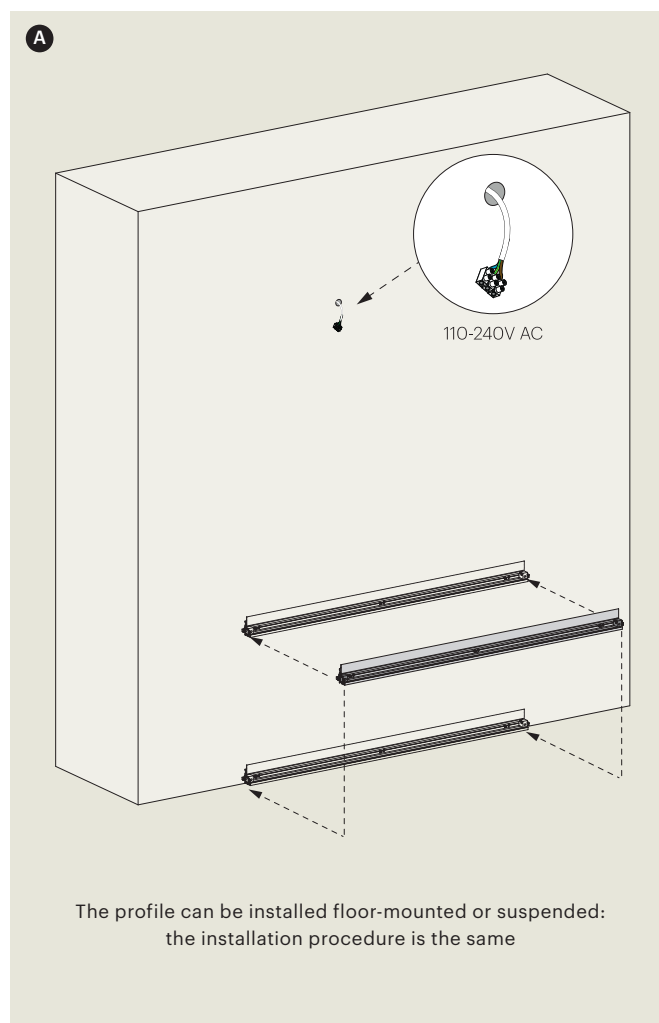

## Lower closing profile

- Wall mounted, leaned on the floor or suspended
- Side profile mounting brackets installed at the ends: neutral (3) or electrified (4 - cable power supply for wallwasher LED)
- Pre-installed adjustment Allen screws (13) (for wall irregularities compensation)
- Optional: wallwasher LED-Reel, complete with polycarbonate screen cover
- Not supplied: screws 3.5x45mm minimum and dowels suitable for the wall material

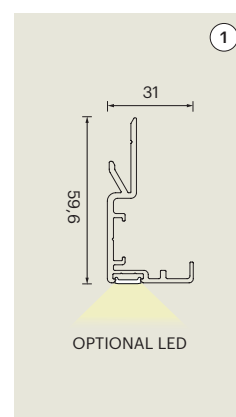

L (mm)= max. 3950mm

custom

# Aluminium structural profiles

03 Black

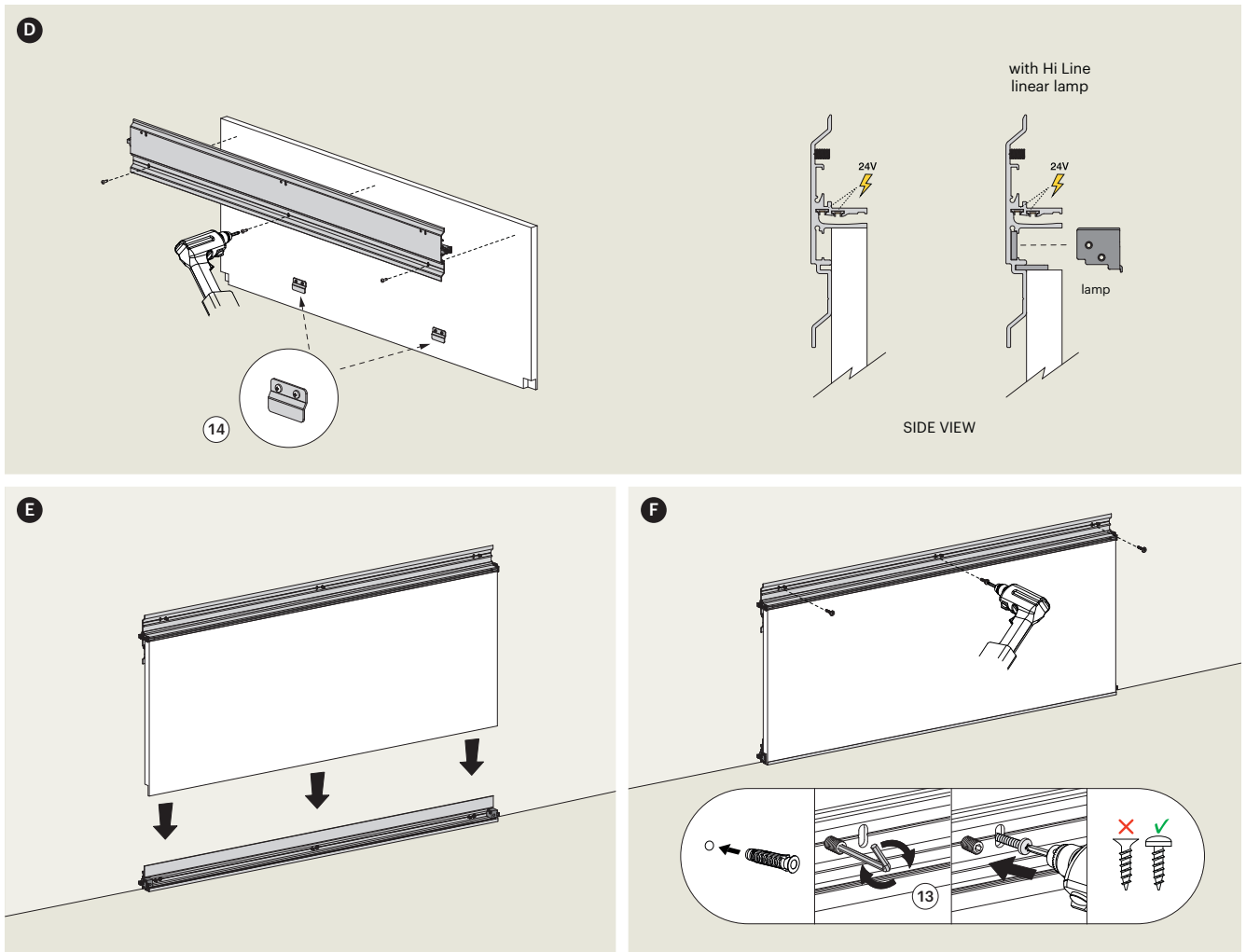

## Rear profile

- To be fixed on paneling wooden back panels
- Mounting brackets installed at the ends for neutral (8) and electrified (7) side profiles
- The accessory groove integrates a pair of concealed conductive tracks (plastic insulated) for light shelves electrification
- Preset for Hi Line magnetic lamp installation
- Pre-installed adjustment Allen screws (13) (for wall irregularities compensation)
- Back panel support brackets (14) included
- Not supplied: screws 3.5x45mm minimum and dowels suitable for the wall material

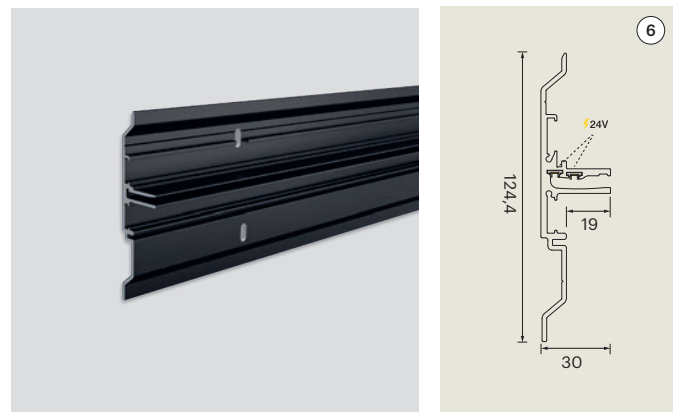

L (mm)= max. 3950mm

custom

# Aluminium structural profiles

03 Black

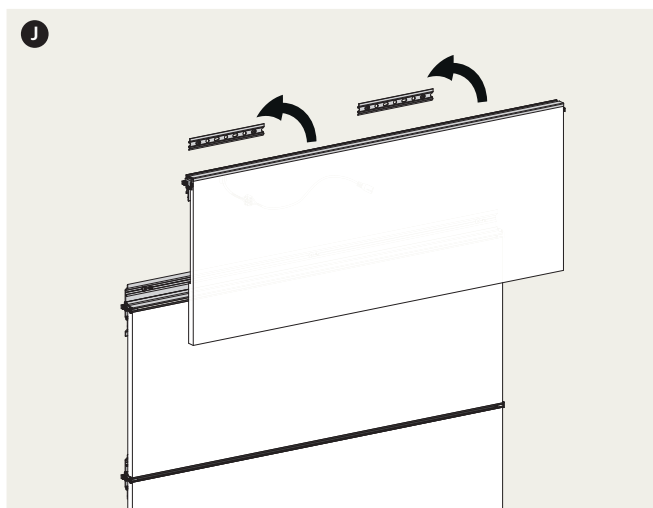
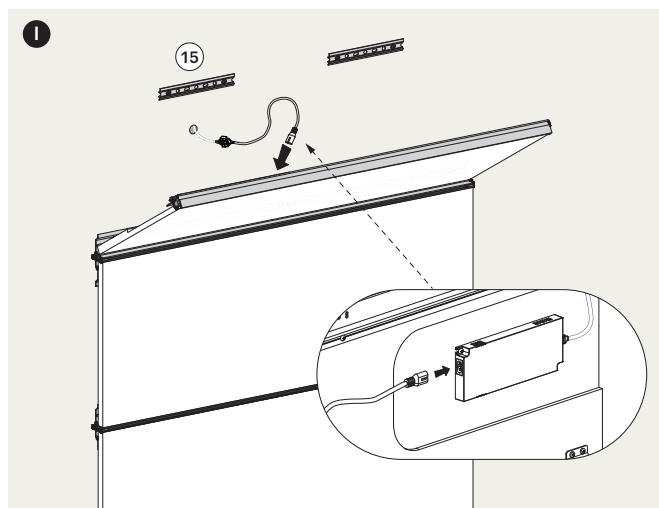
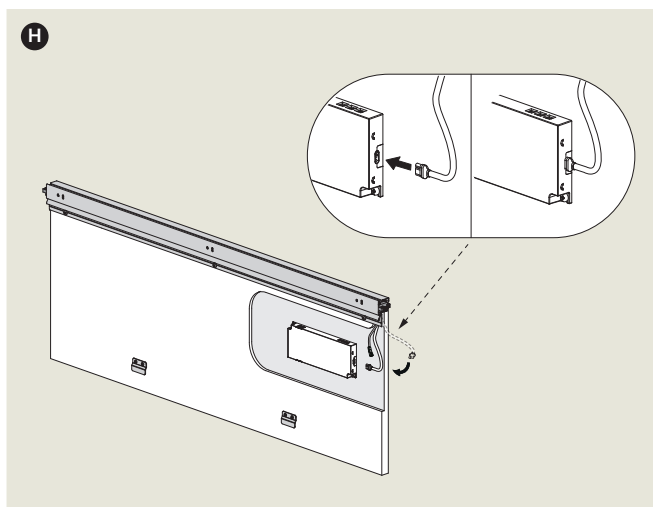
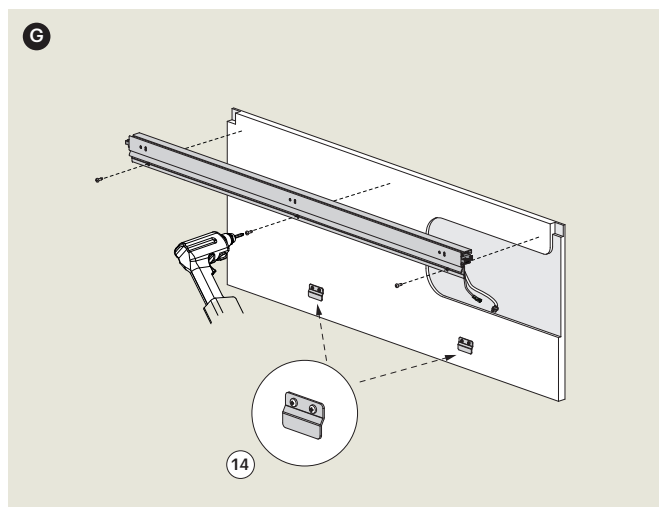

## Upper closing profile

- To be fixed on paneling upper panels; installation by means of wall brackets (15 - supplied)
- Side profile mounting brackets installed at the ends: neutral (3) or electrified (4 - to transmit the electrical signal from the Driver to the electrified side profile - 9 - or, in particular configurations, for LED wallwasher power supply)
- Backrest support brackets (14) included
- Pre-installed adjustment Allen screws (for wall irregularities compensation)
- Optional: wallwasher LED-Reel, complete with polycarbonate screen cover

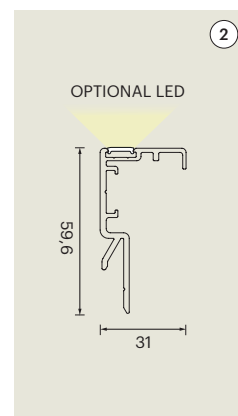
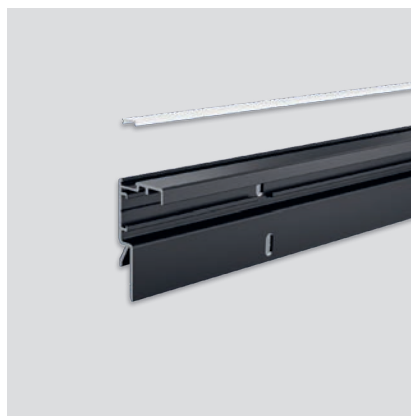

L (mm)= max. 3950mm

custom

# Aluminium structural profiles

03 Black

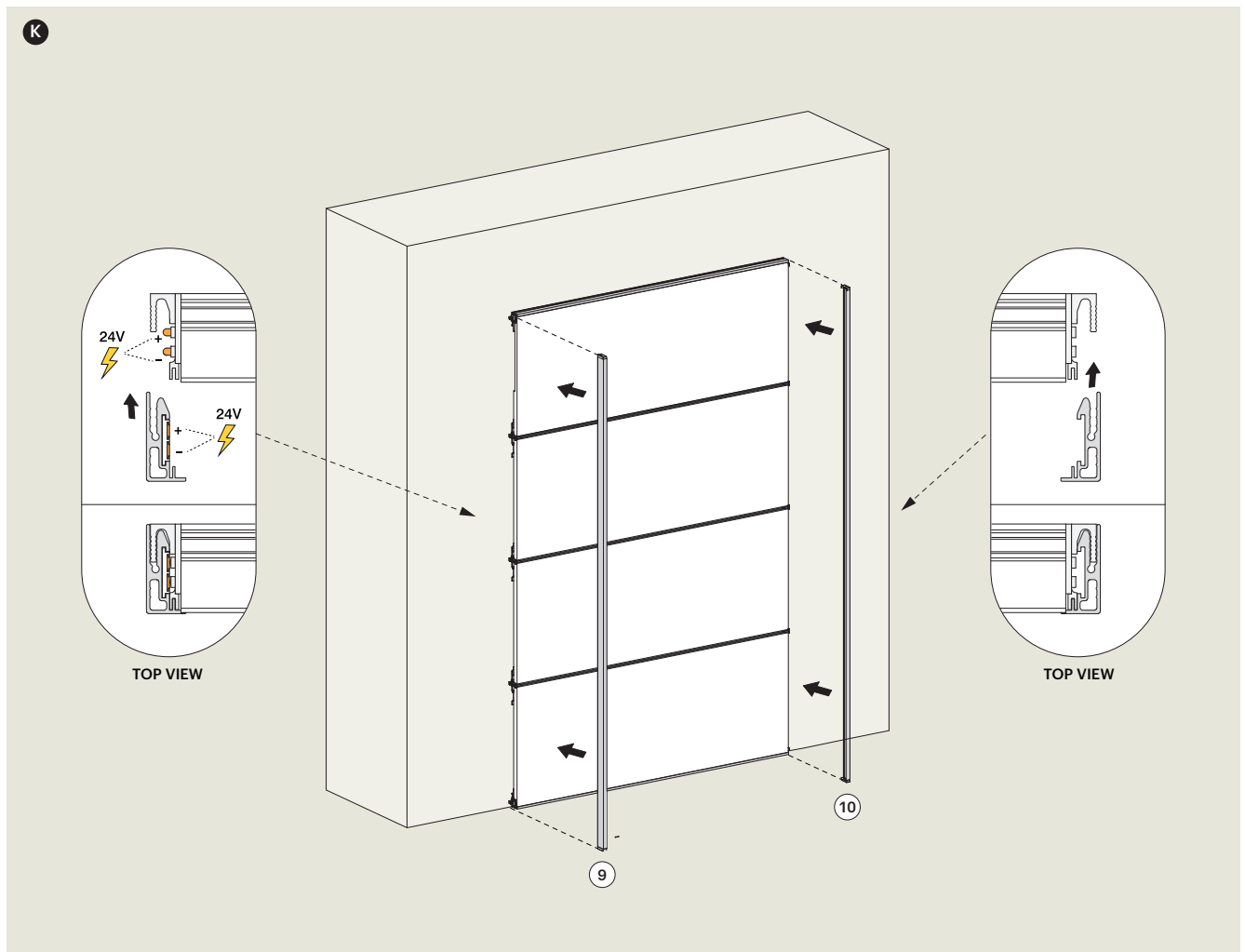

## Side profile

- To be installed at the paneling side on the mounting brackets (3/4/7/8 - pre-assembled on the structural profiles)
- The electrified version (9) integrates a pair of concealed conductive tracks (plastic insulated), necessary to transmit electrification to all rear profiles (6) of the paneling
- Supplied complete with plastic terminals

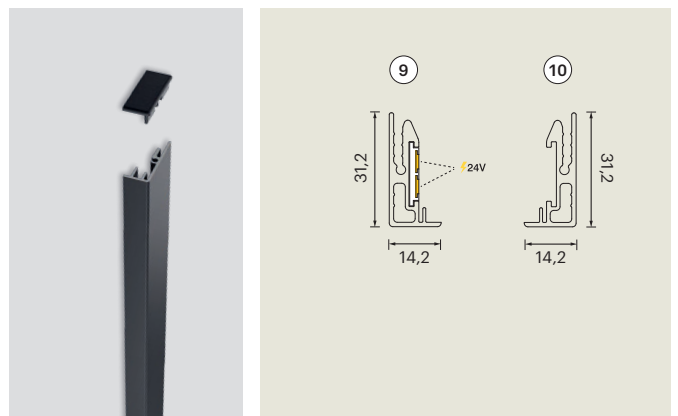

L (mm)= max. 3950mm

custom

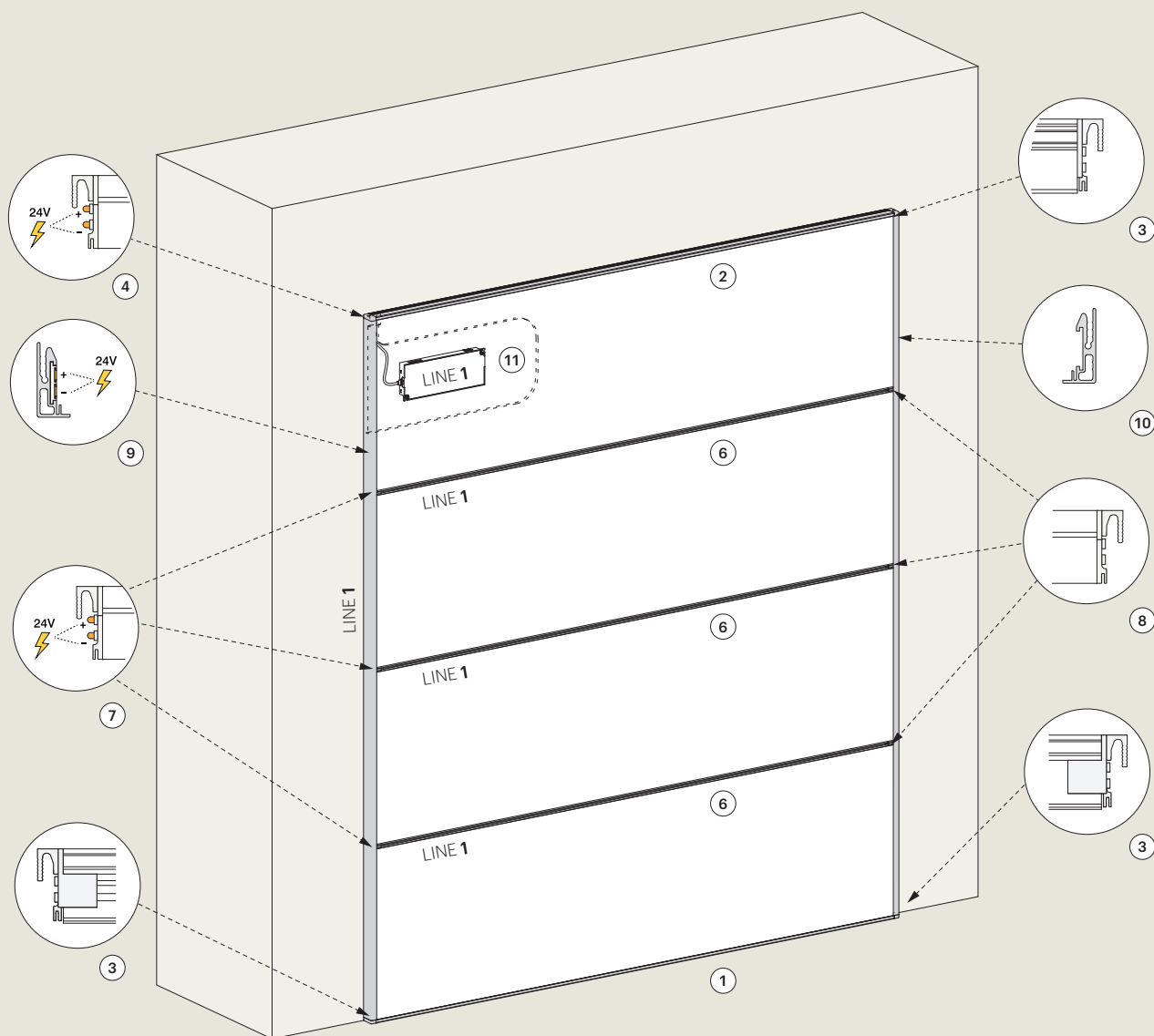

## Configuration with single electrified side profile

Single LED Driver configuration, ideal for panelings without wall-washer lighting: the electrified side profile mounting bracket (4) installed on the upper closing profile (2) is connected via cable to the Driver and transmits the electrical signal (LINE 1) to a single electrified side profile (9 - with integrated conductive tracks). All the rear profiles (6) so receive the signal via electrified side profile mounting brackets (7) which are configured and pre-assembled on the same side (left) as the electrified side profile (9).

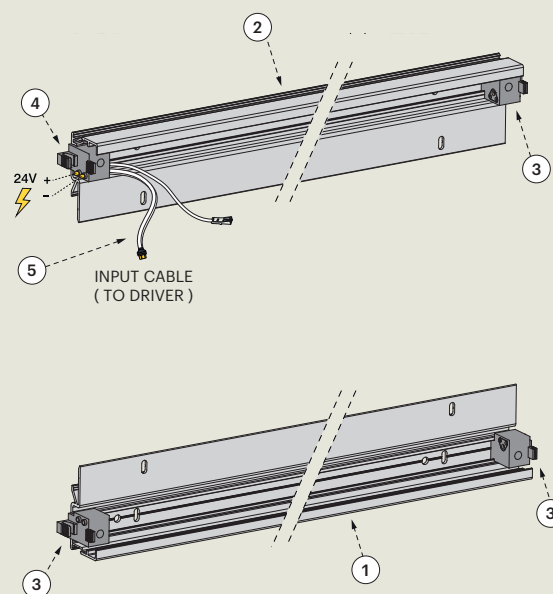

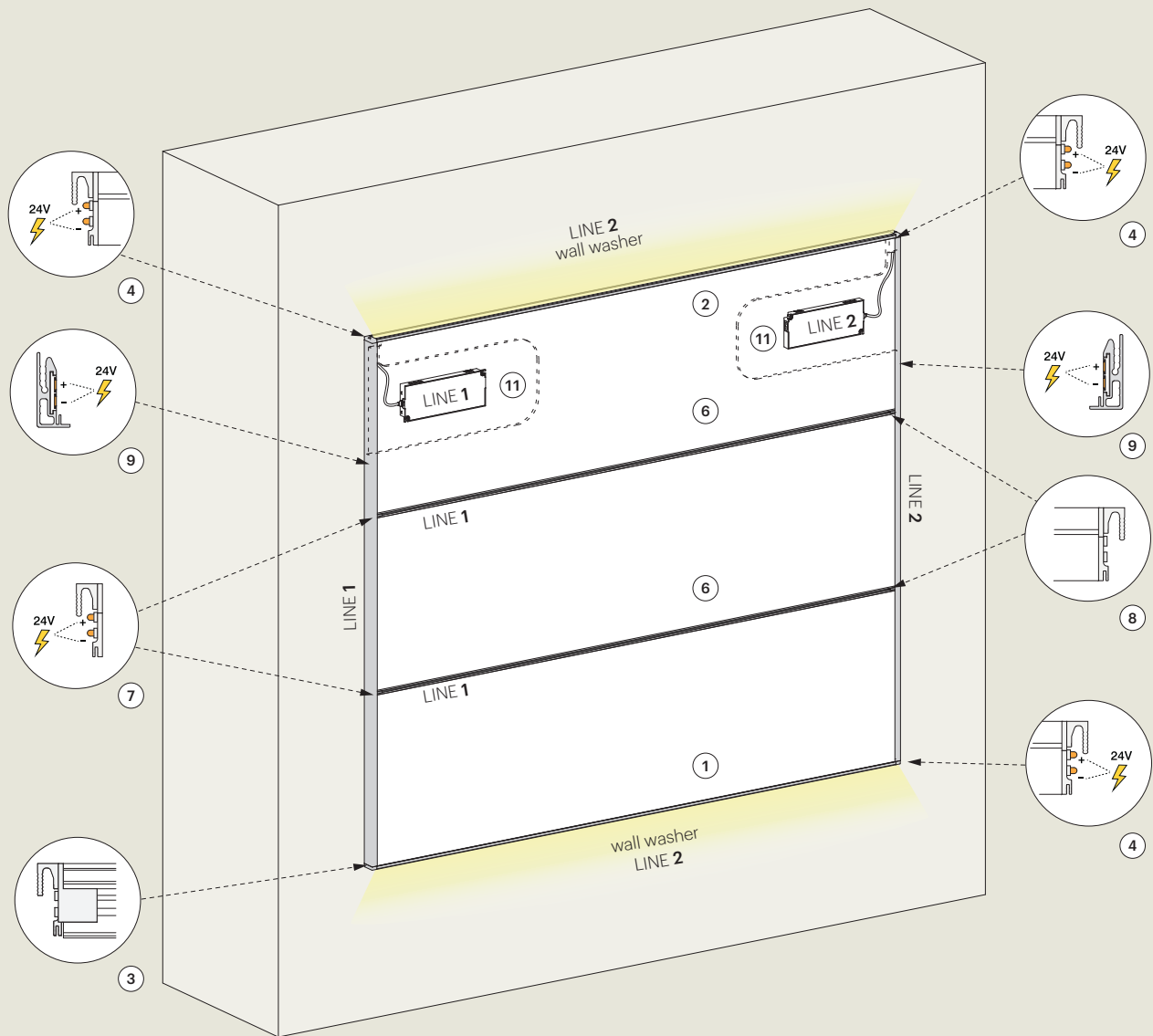

## Configuration with double electrified side profile

Double LED Driver configuration, ideal for panelings with high LED load (W) (e.g. wall washer): the upper closing profile (2) is configured on both sides with electrified side profile mounting brackets (4) which, connected via cable to two Drivers, transmit two separate electrical signals (LINE 1 / LINE 2) to the side profiles, both electrified (9 - with integrated conductive tracks). The lower closing profile (1) and all the rear profiles (6) so receive the signal via electrified side profile mounting brackets (4/7) which are configured and pre-assembled to the right or left of the profiles for optimal distribution of the LED load (W) on the two lines.

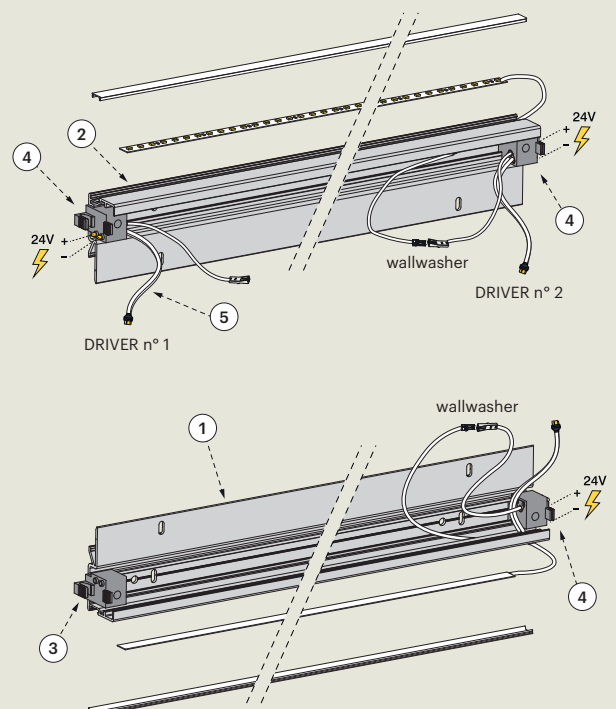

## Repositionable illuminated shelf

03 Black

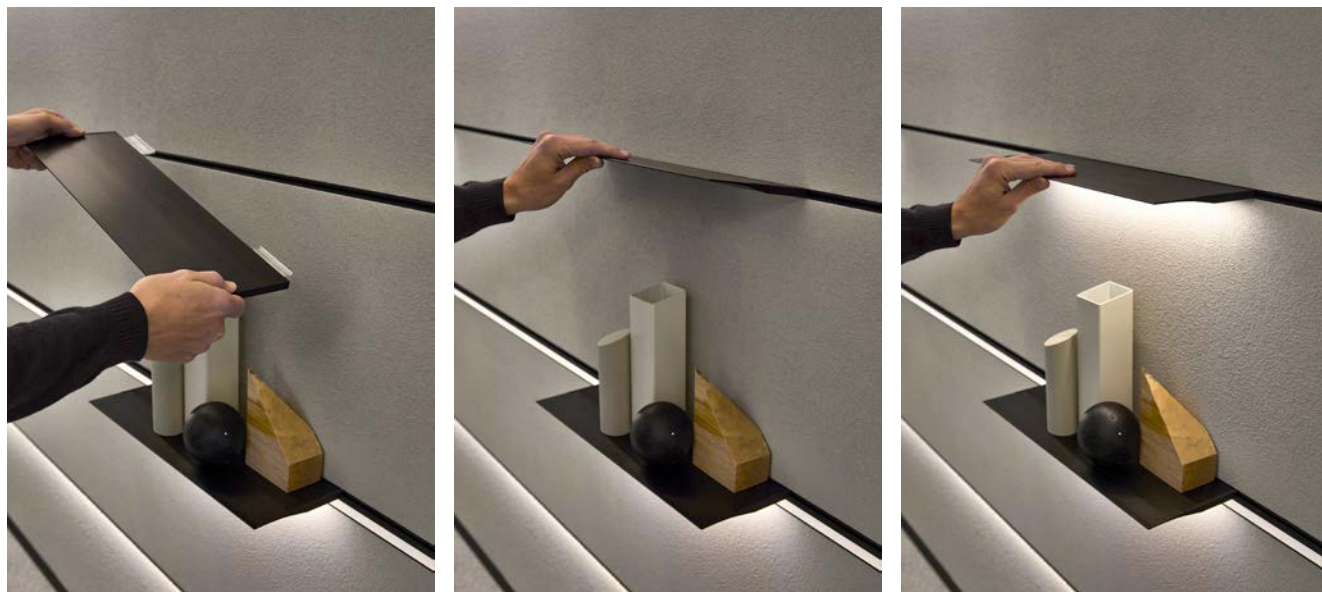

- Thin and elegant, only 2mm thick at the front, the Hi Line luminous shelves enhance every space by creating blades of diffused light with great visual impact
- Easy and intuitive assembly
- Without cables, powered by the paneling rear profile (6) via plastic insulated shelf bracket
- Made of brushed, scratch-resistant extruded aluminum in black finish, with polycarbonate screen cover and plastic sides
- Maximum load: 5Kg evenly distributed
- EDC Dual Color LED source with adjustable color temperature (3000K or 4000K)

**24V DC | LED 10W/m**

EDC 3000K-4000K

L (mm)= 600 / 900 / 1200 / 1500

on request

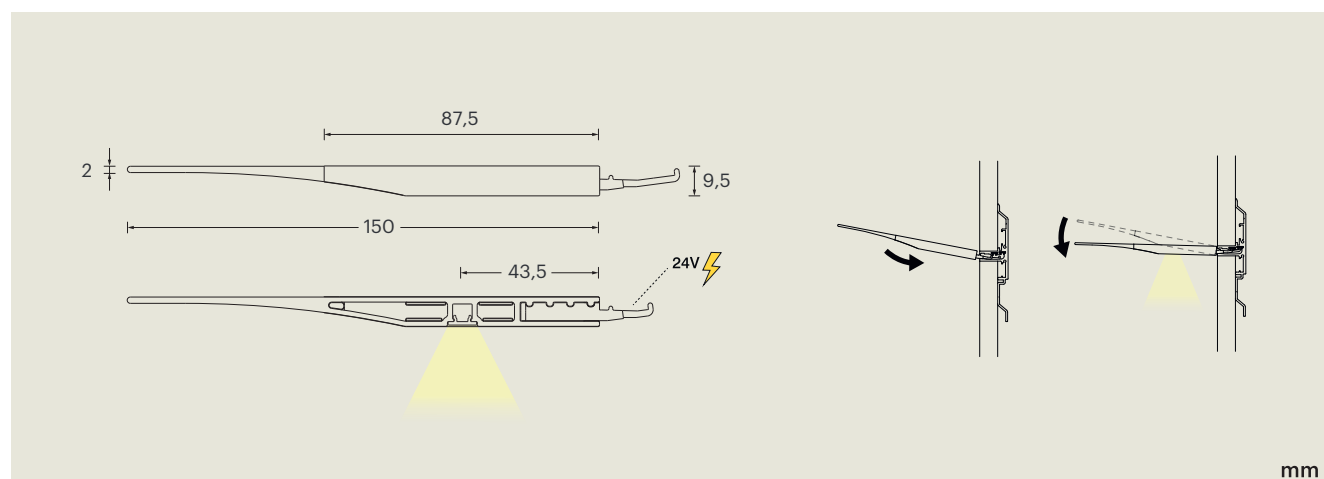

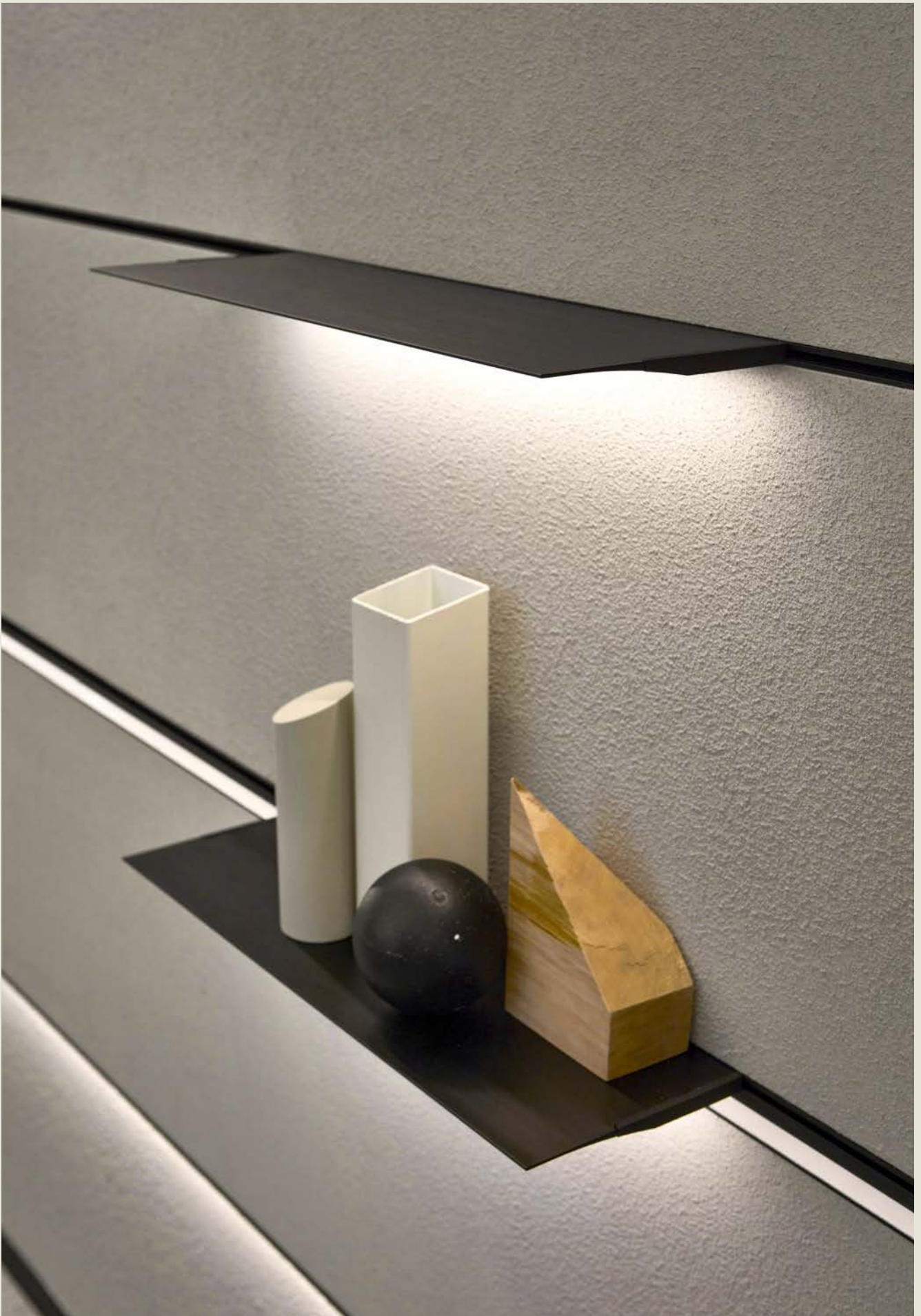



## Magnetic linear lamp

03 Black

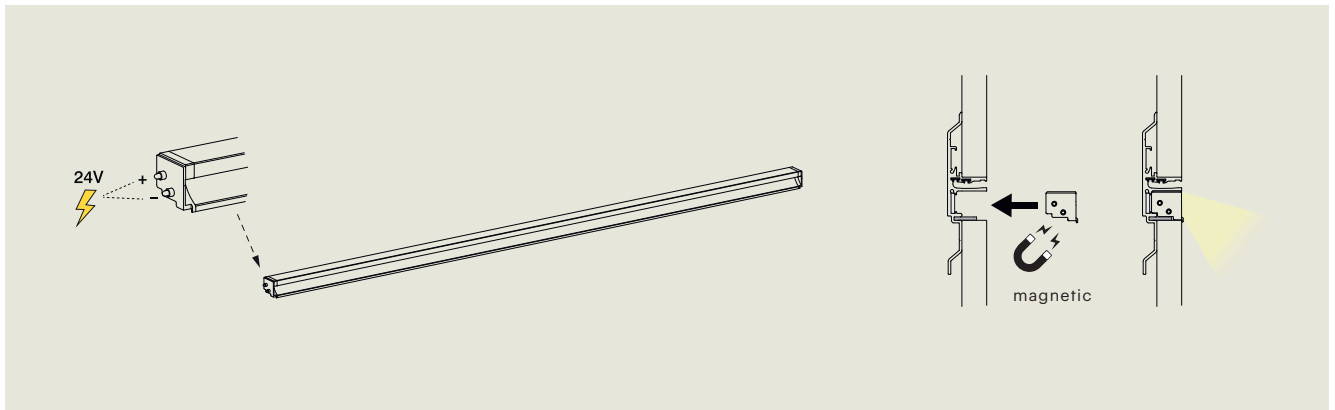

- Without cables: powered by electrified side profile (9) via electrified pin contacts on the sides
- Easy magnetic fixing inside rear profile (6)
- Made of extruded aluminum in black finish, complete with polycarbonate screen cover
- EDC Dual Color LED Light source, with adjustable color temperature (3000K or 4000K)

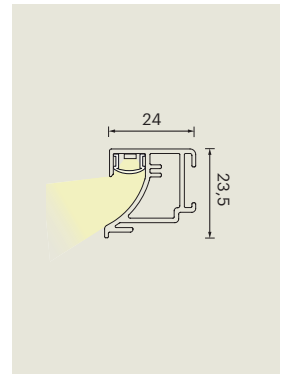

24V DC | LED 10W/m

EDC 3000K-4000K

L (mm)= 600 / 900 / 1200 / 1500 / 1800

on request

## Wall-Washer LED

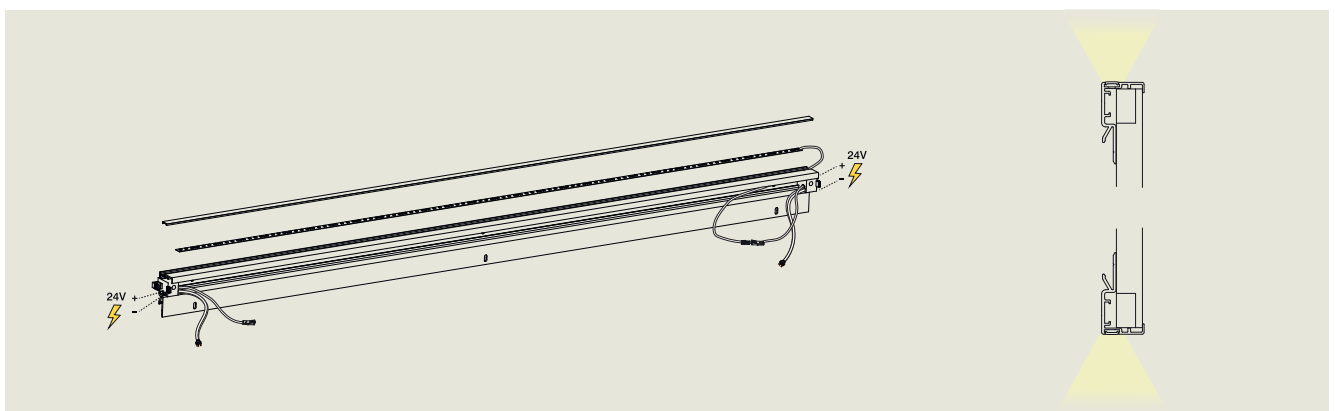

- Supplied installed in the lower (1) or upper (3) closing profiles
- Powered via cable, connected to cabled electrified side profile mounting bracket (4)
- EDC Dual Color LED Light source, with adjustable color temperature (3000K or 4000K)

24V DC | LED 10W/m

EDC 3000K-4000K

custom

# Illuminated cabinet modules

03 Black

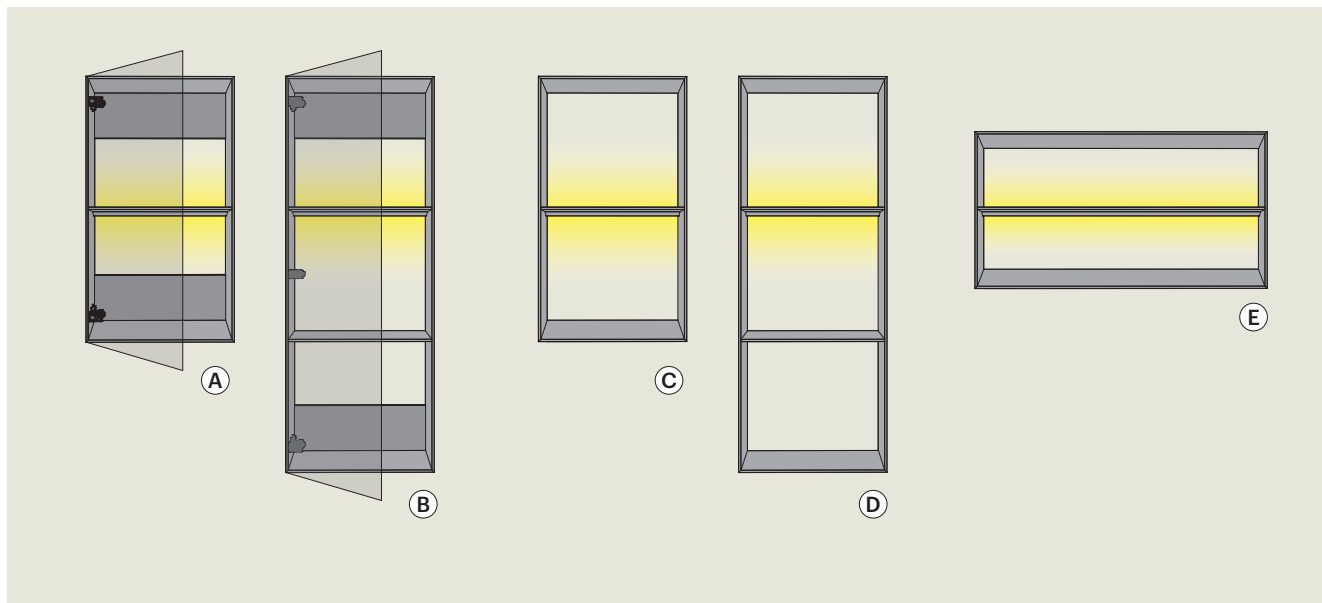

- Horizontal or vertical modules made of black scratch-resistant brushed aluminium
- Available in open version or with single door in Stopsol smoked glass
- Fixed depth 150mm
- Maximum load: 1Kg every 100mm
- Integrated double emission (upper and lower) light shelf without cables, powered by the paneling rear profile (6) via plastic insulated shelf bracket
- EDC Dual Color LED Light source, with adjustable color temperature (3000K or 4000K)

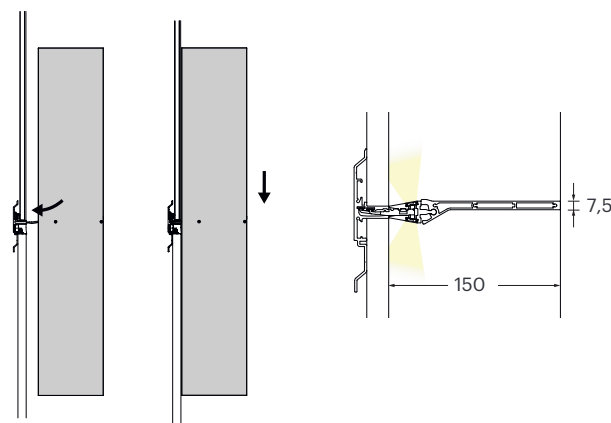
**24V DC | LED 10W/m**

EDC 3000K-4000K

**VERTICAL MODULES WITH STOPSOL GLASS DOOR**

<b>A</b>	450 x 150 x h 800mm	2 x compartments	8,6W	<b>523100003</b>
<b>B</b>	450 x 150 x h 1200mm	2 x compartments	8,6W	<b>523100004</b>

**VERTICAL MODULES**

<b>C</b>	450 x 150 x h 800mm	2 x compartments	8,6W	<b>523100001</b>
<b>D</b>	450 x 150 x h 1200mm	3 x compartments	8,6W	<b>523100002</b>

**HORIZONTAL MODULES**

<b>E</b>	600 x 150 x h 450mm	2 x compartments	11,6W	<b>523100006</b>
	900 x 150 x h 450mm	2 x compartments	17,6W	<b>523100005</b>

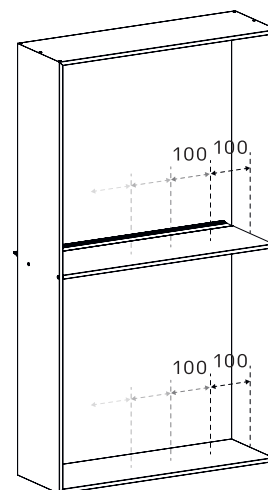

max: 1kg x 100mm

# Cabinet modules

03 Black

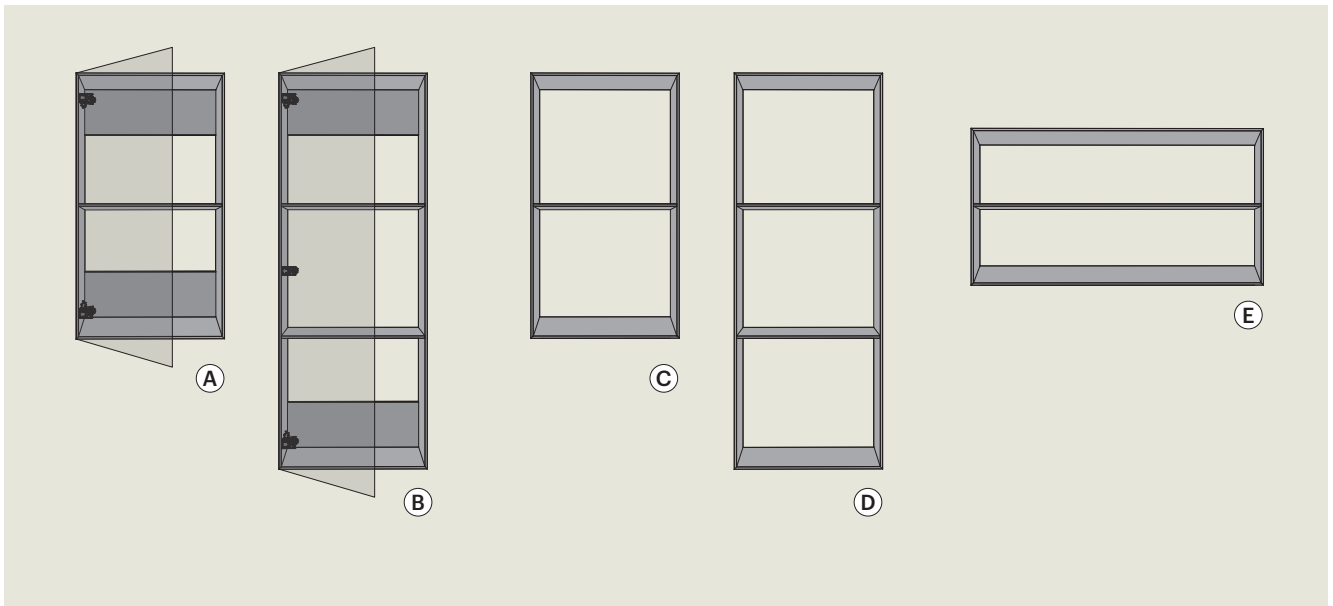

- Horizontal or vertical modules made of black scratch-resistant brushed aluminium
- Snap-fit installation on paneling real profile (6)
- Available in open version or with single door in Stopsol smoked glass
- Fixed depth 150mm
- Maximum load: 1Kg every 100mm

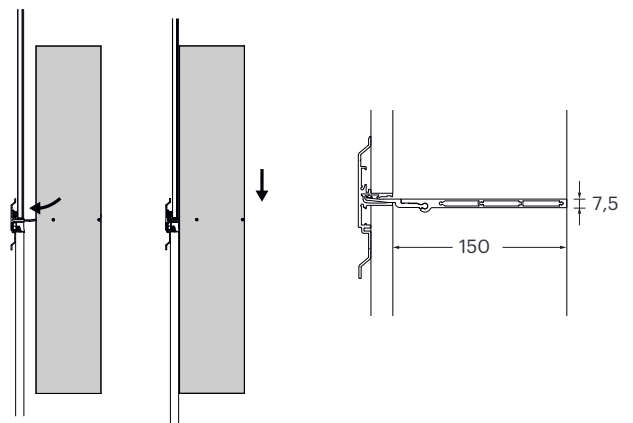

## VERTICAL MODULES WITH STOPSOL GLASS DOOR

A	450 x 150 x h 800mm	2 x compartments	92900210300
B	450 x 150 x h 1200mm	2 x compartments	92900220300

## VERTICAL MODULES

C	450 x 150 x h 800mm	2 x compartments	92900050300
D	450 x 150 x h 1200mm	3 x compartments	92900060300

## HORIZONTAL MODULES

E	600 x 150 x h 450mm	2 x compartments	92900250300
	900 x 150 x h 450mm	2 x compartments	92900240300

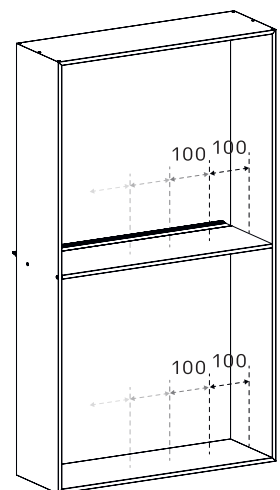

max: 1kg x 100mm

# Aluminium accessories

03 Black

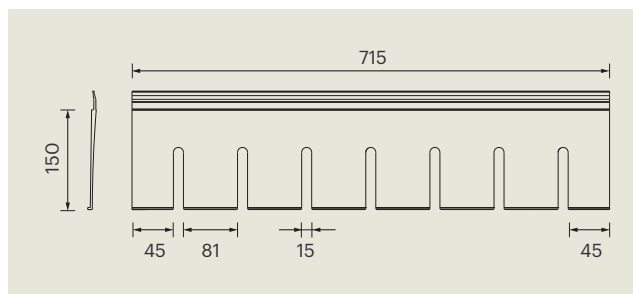
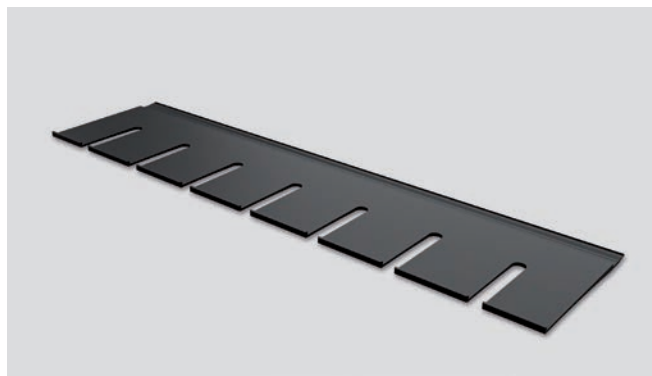
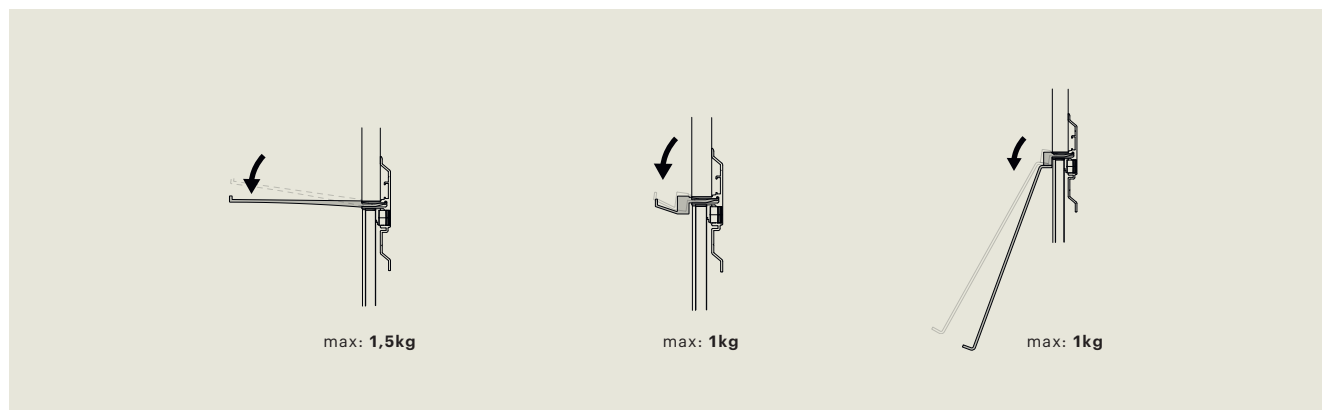
**GLASS HOLDER 715mm**

715 x 150mm - Front edge: 7mm

92900150300

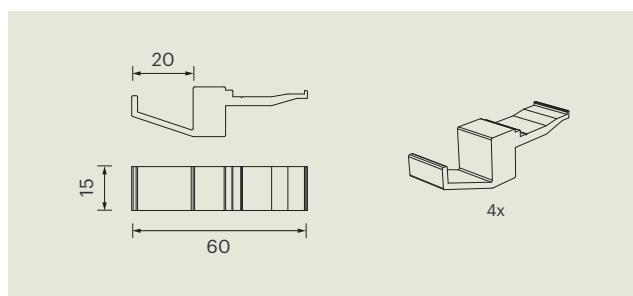
**HOOK SET**

4 x Hooks

92900170300

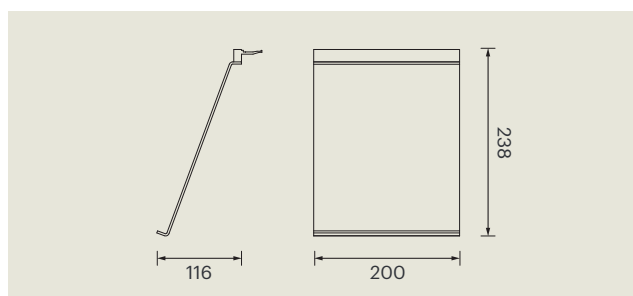
**TABLET HOLDER**

330 x 118 x 20mm

92900200300

# Aluminium shelves

03 Black

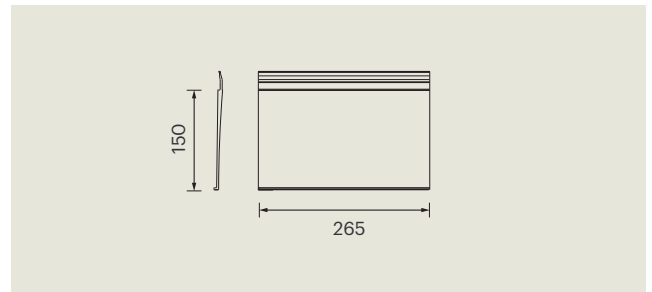
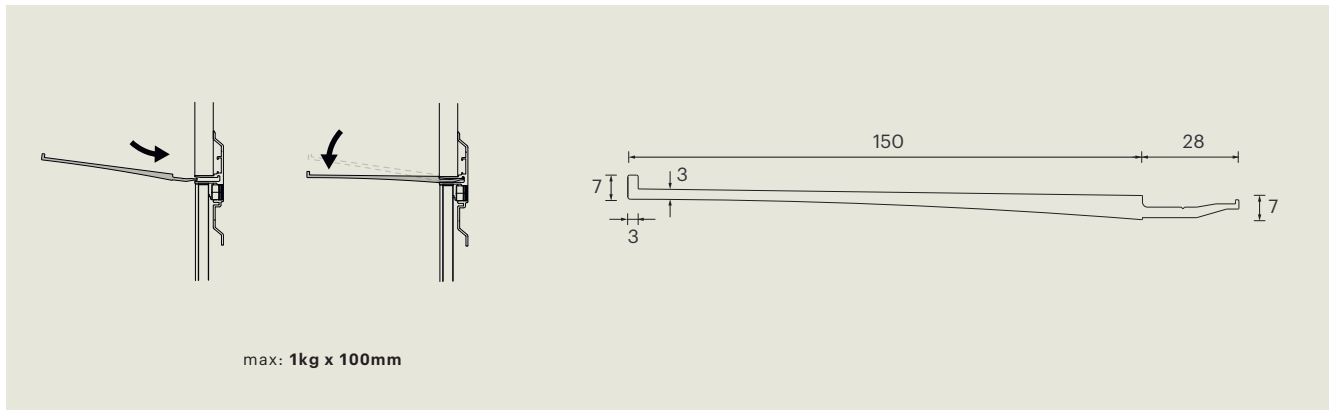
**SHELF 265mm**

265 x 150mm - Front edge: 7mm

92900230300

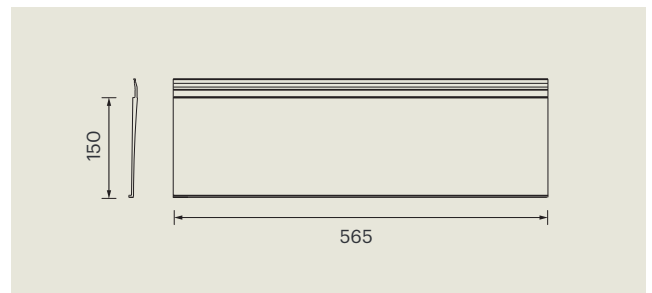
**SHELF 565mm**

565 x 150mm - Front edge: 7mm

92900100300

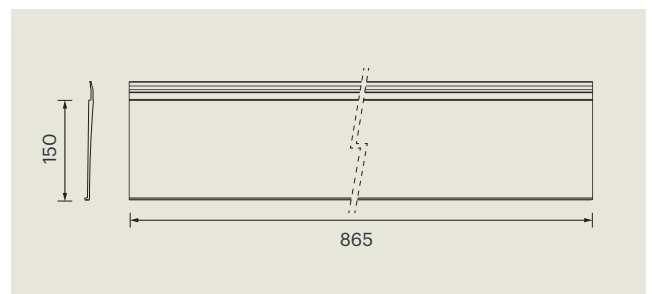
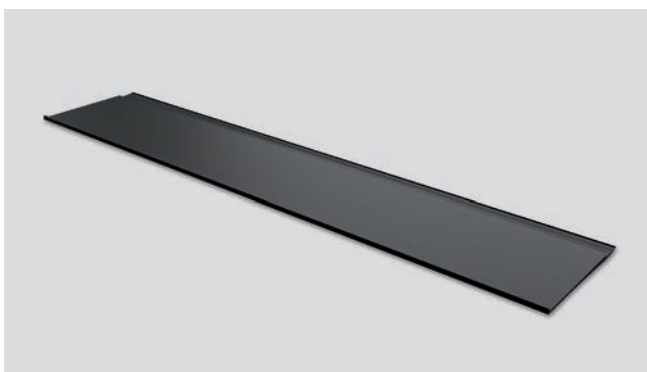
**SHELF 865mm**

865 x 150mm - Front edge: 7mm

92900120300

## Wooden back panels

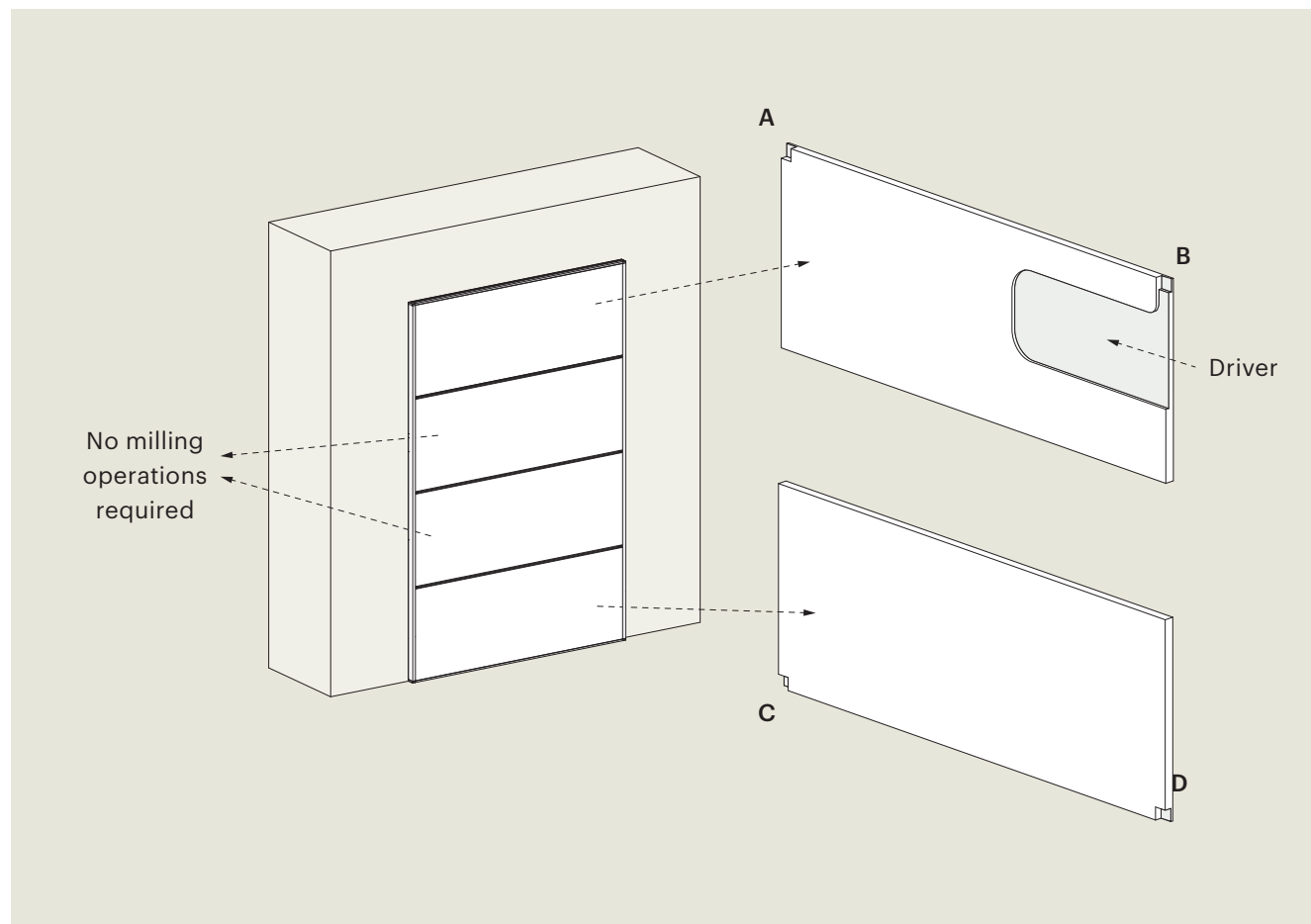

### Thickness 19mm

The rear of the paneling back panels (by the furniture maker) may require specific milling to house connection systems, wiring and Drivers. The recess for housing the Driver (minimum depth 7mm) is sized based on the overall dimension of the Driver used, including any possible control modules. Different configurations of the Hi Line system (e.g. integrated wallwasher light) may require the installation of n°2 Drivers

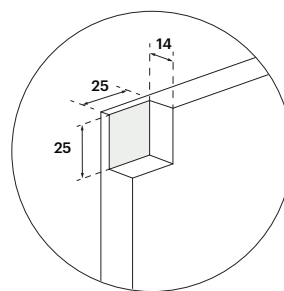

DET. A

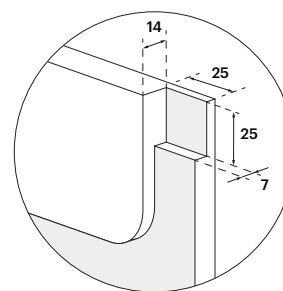

DET. B

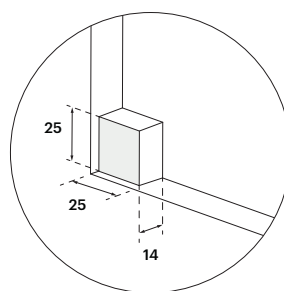

DET. C

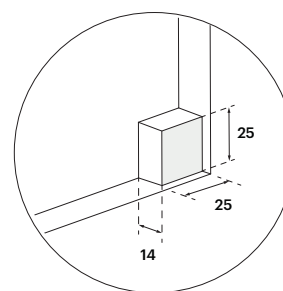

DET. D



## Schemi di collegamento

### Single Driver connection

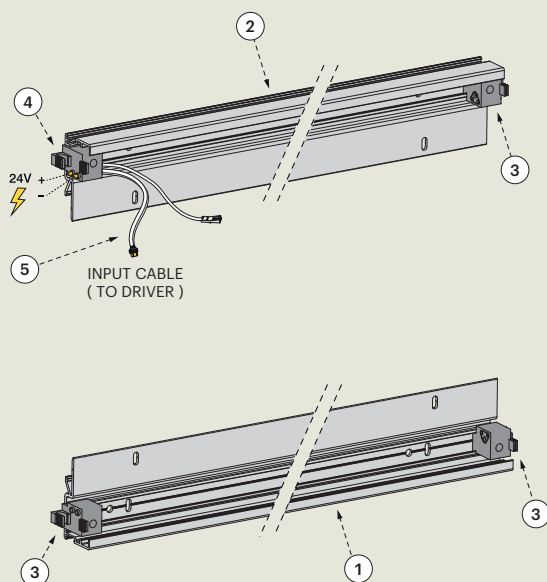

### Double Driver Connection (e.g. Wall Washer)

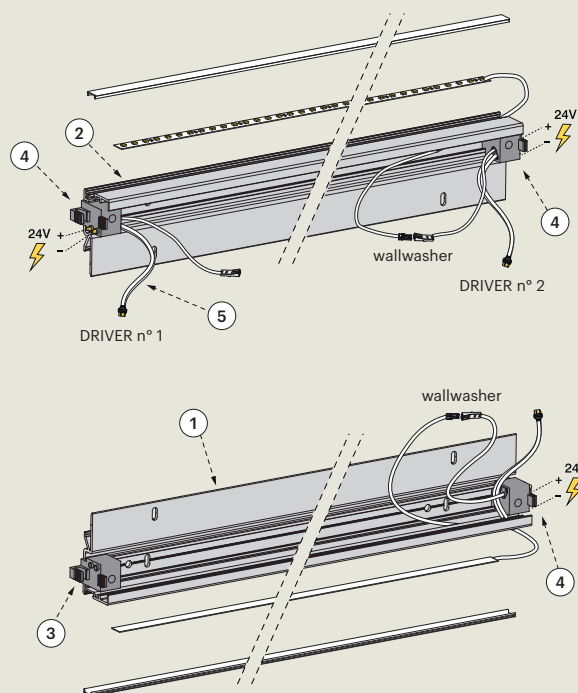

### Power Supply only

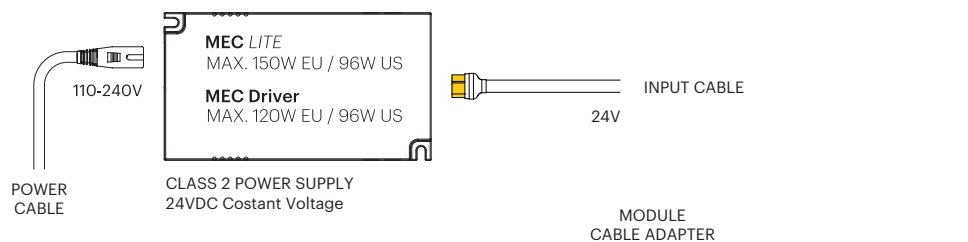

### Remote Control

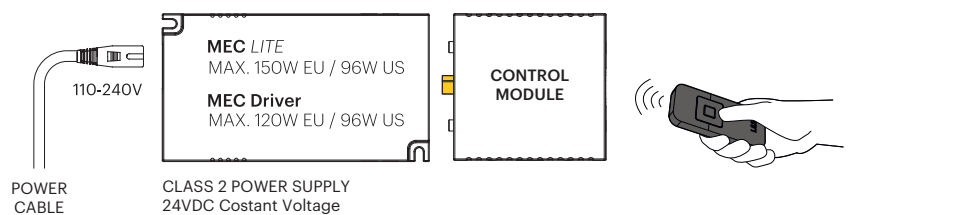

NOTE: Driver, power cable and remote control solutions are not included.

The number of installable light fixtures always depends on the power (W) supplied by the Driver, which must always be at least 10% higher than the total load (W) of the fixtures



The information present in this catalog may be subject to errors. The articles, their characteristics, data and dimensions found therein are not binding and may be subject to change without prior notice from the company.

## HEADQUARTERS

## OUR SUBSIDIARIES

### ITALY

**Brugnera**  
Via L. Zanussi, 8  
Maron di Brugnera (PN)  
+39 0434 616611  
info@ls-light.com

**Varese**  
Via Pacinotti, 54  
Varese (VA)  
+39 0332 491247  
info@formaefunzione.com

**Tavullia**  
Via del Lavoro, 4  
Tavullia (PU)  
+39 0721 901123  
info@italpek.it

**Recanati**  
Via Armando Cingolani, 13  
Zona Ind.le P.I.P.  
Sambucheto di Recanati  
Recanati (MC)  
+39 071 0960086  
sales@fluxitalia.com

### GERMANY

**L&S Deutschland GmbH**  
Daimlerring, 34  
Rödinghausen  
+49 5223 8790-0  
info@ls-light.de

### CHINA

**LS Lighting Equipment**  
(Shanghai) Co., Ltd.  
No. 255, LongPan Rd.,  
Malu Town,  
Jiading District, Shanghai  
+86 021 69 15 67 91  
info.china@ls-light.com

### UNITED STATES

**L&S Lighting Corporation**  
1505 Pavilion Place, Suite A  
Norcross, Georgia  
+1 877 877 0757  
info.us@ls-light.com



